

JAN 26 1998

STATE OF MICHIGAN COUNTY OF CHARLEVOIX RECEIVED FOR RECORD

96 DEC 11 PM 3:11

SECTION

LAND CORNER RECORDATION CERTIFICATE Filing Requirement of Act 74, Mich. P.A. 1970

Charlene M. Chamberlain REGISTER OF DEEDS

SURVEY & REMONUMENTATION

JAN 26 1998

Register of Deeds Stamp & File Number

For corners in Charlevoix

Table with columns: Located In: (County), Corner Code #, and rows for Public Land Survey, Property Controlling In Section, Miscellaneous Property in Sec.

4. Lot No. Recorded Plat 5. Private Claims

I, Wayne E. Boss, in a field survey on OCTOBER 14, 1996, do hereby certify that under requirements of P.A. 74, Michigan P.A. of 1970, the corner points mentioned in lines 1 and 2 above were in conformance with regulations and rules therefore as required in the current manual of survey instructions of the United States Department of the Interior, Bureau of Land Management or by a decree of a Court of Law and/or that the corner points mentioned in lines 3, 4 and 5 above were in conformance with the rules of the Michigan Board of Land Surveyors or by a Decree of a Court of Law; established, re-established, monumented, re-monumented, recovered, found as expressed below:

NOTE: Not more than 4 corners, all in the same town and range, may be recorded on this certificate.

Grid table with columns A-K and rows 2-13, containing numbers 1-36.

A. Description of original monument and accessories and/or subsequent restoration:

- M-1 GLO JUNE 1839 JOHN HODGSON SET POST AT INTER-SECTION COR. TWP. 32 & 33 N., 6 & 7 W. 1. BEECH 7 N35W 23 LKS. 2. BEECH 7 S74W 18 LKS. JUNE 1877 E.K. ROBINSON

B. Description of corner evidence found and/or method applied in restoring or reestablishing corner:

- M-1 1/2" IRON FOUND WITH CAP(FERGUSON & CHAMBERLAIN). NO DIRECT TIE TO GLO. 4. N60E 90.0' 28" MAPLE 6. WEST 32.63' T-IRON FD. 7.PWR. POLE S26E 88.78' 8. 12" APPLE S66W 100.30' 9. TELE. BOX N10W 60.35' 10. ROAD SIGN N80E 41.26'

C. Description of monument for corner and accessories established to perpetuate locating the position of the corner:

- M-1 & M-13 TOWNSHIP CORNER COMMON TO M-1 T32N-R7W & M-13 T33NN-R7W & A-1 T32N-R6W & A-13 T33N-R6W. CHARLEVOIX CO. MON. SET 4. N60E 90.2' 28" MAPLE (SPIKE & TAG SET) 6. WEST 32.63' T-IRON FOUND 7. S26E 88.78' POWER POLE SPIKE FOUND 8. 12" APPLE S66W 100.30' 9. N10W 60.48' CTR. OF TELE. RISER 10. N70E 24.35' AT SIGN POST AND IS ACCEPTED AS THE BEST AVAILABLE EVIDENCE OF THE POSITION OF THE ORIGINAL CORNER.

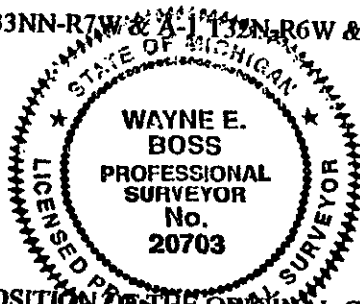

Signed by [Signature] Date 11/27/96 Surveyor's Michigan License No. 20703 LIBER 003 PAGE 85

367/30
725

A. con't

- 8. 12" APPLE S66W 100.30'
- 9. TELE. BOX N10W 60.35'
- 10. ROAD SIGN N80E 41.26'

**SURVEY &
REMONUMENTATION**

JAN 26 1998

SECTION