

SURVEY &  
REMONUMENTATION

NOV 21 1997

COMMISSION

For corners in  
Charlevoix

(County)

Located In:

Corner Code ##

1. Public Land Survey

T 32N R 7W ✓  
T 32N R 6W

M-5

A-5

2. Property Controlling  
in Section

S T R  
S T R

3. Miscellaneous  
Property in Sec.

S T R  
S T R

4. Lot No. \_\_\_\_\_, Recorded Plat \_\_\_\_\_

5. Private Claims \_\_\_\_\_

I, Wayne E. Boss, in a field survey on OCTOBER 24, 1996,  
do hereby certify that under requirements of P.A. 74, Michigan P.A. of 1970, the corner points mentioned  
in lines 1 and 2 above were in conformance with regulations and rules therefore as required in the  
current manual of survey instructions of the United States Department of the Interior, Bureau of Land  
Management or by a decree of a Court of Law and/or that the corner points mentioned in lines 3, 4 and 5  
above were in conformance with the rules of the Michigan Board of Land Surveyors or by a Decree of a  
Court of Law; established, re-established, monumented, re-monumented, recovered, found as  
expressed below:

**NOTE: Not more than 4 corners, all in the same town and range, may be recorded  
on this certificate.**

A. Description of original monument and accessories and/or subsequent restoration:

M-5 GLO SEPT. 1856  
E.D. ATWATER  
SET CORNER OF SECT. 12 & 13  
1. SUGAR 12 N60W 53 LKS.  
2. BEECH 8 S62W 15 LKS.

E.K. ROBINSON FD. & USED  
COR. POST IN MAY 1886  
SURVEY. NO NEW WIT

E.A. ROBINSON APRIL 1913  
FD. COR. REPLACED WITH  
¾" X 30" PIPE  
3. BEECH 12 N73E 30 LKS

W. BOSS IN NOV. 1973 FD. ½"  
REINF. IRON SET BY UNKNOWN  
4. 8" MAPLE N53W 61.01'  
5. 18" MAPLE NORTH 70.20'  
6. 1/2" IR. SOUTH 33.0'  
B. JONES RESET COR. FROM WIT  
AND ADDED 1 WIT.  
7. 10" POPLAR S40E 17.24'

B. Description of corner evidence found and/or method applied in restoring or reestablishing corner:

M-5 ½" IR. FD. LOCATION REESTABLISHED BY BERYL JONES FROM WIT.  
4. 8" MAPLE N53W 61.01'  
5. 18" MAPLE (ACTUALLY A BEECH) NORTH 70.20'  
6. ½" IR. SOUTH 33.0'  
7. 10" POPLAR S40E 17.24'

C. Description of monument for corner and accessories established to perpetuate locating the position of the corner:

M-5 & A-5 M-5 T32N-R7W COMMON CORNER TO A-5 T32N-R6W.  
CHARLEVOIX CO. MON. SET  
4. 8" MAPLE N53W 61.01'  
5. 18" MAPLE (ACTUALLY A BEECH) NORTH 70.20'  
6. ½" IR. SOUTH 33.0'  
7. 10" POPLAR S40E 17.24'  
AND IS ACCEPTED AS THE BEST AVAILABLE EVIDENCE OF THE POSITION OF THE ORIGINAL CORNER.

STATE OF MICHIGAN  
COUNTY OF CHARLEVOIX  
RECEIVED FOR RECORD

97 JAN -9 PM 3:37

LAND CORNER RECORDATION CERTIFICATE  
Filing Requirement of Act 74, Mich. P.A. 1970

*Charles M. Cobble*  
REGISTER OF DEEDS

Register of Deeds Stamp & File Number

	A	B	C	D	E	F	G	H	I	J	K	L	M
2	6	5	4	3	2	1							
3													
4	7	8	9	10	11	12							
5													
6	18	17	16	15	14	13							
7													
8	19	20	21	22	23	24							
9													
10	30	29	28	27	26	25							
11													
12	31	32	33	34	35	36							
13													

Charlevoix Co. Surveyor  
**APPROVED**

Signature: Wayne E. Boss  
Date: Jan. 9, 1997

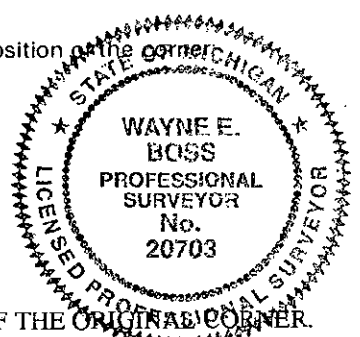

Signed by *Wayne E. Boss* Date 11/29/96

Surveyor's Michigan License No. 20703

LIBER 003 PAGE 93