

**SURVEY & REMONUMENTATION**

**JAN 26 1998**

**SECTION**

**LAND CORNER RECORDATION CERTIFICATE**  
Filing Requirement of Act 74, Mich. P.A. 1970

STATE OF MICHIGAN  
COUNTY OF CHARLEVOIX  
RECEIVED FOR RECORD

97 DEC 15 PM 2:49

*Charles M. Boss*  
REGISTER OF DEEDS

For corners in

Charlevoix

(County)

Located In:

Corner Code #

1. Public Land Survey

T 32NR 7W

M-6

T          

T 32NR 6W

A-6

T          

2. Property Controlling in Section

S      T      R     

S      T      R     

3. Miscellaneous Property in Sec.

S      T      R     

S      T      R     

Register of Deeds Stamp & File Number

4. Lot No.         , Recorded Plat         

5. Private Claims         

Wayne E. Boss

May 97

I, Wayne E. Boss, in a field survey on May 97, do hereby state that under requirements of P.A. 74, Michigan P.A. of 1970, the corner points mentioned in lines 1 and 2 above were in conformance with regulations and rules therefore as required in the current manual of survey instructions of the United States Department of the Interior, Bureau of Land Management or by a decree of a Court of Law and for that the corner points mentioned in lines 3, 4 and 5 above were in conformance with the rules of the Michigan Board of Land Surveyors or by a Decree of a Court of Law, established, re-established, monumented, recovered, found as expressed below:

NOTE: Not more than 2 corners, all in the same town and range, may be recorded on this certificate.

	A	B	C	D	E	F	G	H	I	J	K	L	M
1													
2	6		5		4		3		2		1		
3													
4	7		8		9		10		11		12		
5													
6	18		17		16		15		14		13		
7													
8	19		20		21		22		23		24		
9													
10	30		29		28		27		26		25		
11													
12	31		32		33		34		35		36		
13													

A. Description of original monument and accessories and/or subsequent restoration:

M-6 JUNE 1839

JOHN HODGSON, DEPUTY SURVEYOR  
SET POST

- 1. BEECH 14 INCH S81E 24 LKS
- 2. MAPLE 5 INCH S71W 25 LKS

APRIL 30, 1992

BERYL M. JONES  
FOUND IRON ORIGIN UNKNOWN

- 3. 12" YELL. BIRCH N82W 11.70'
- 4. 14" CLUSTER MAPLE N60E 24.65'
- 5. 20" MAPLE NORTH 18.40'
- 6. 25" TWIN MAPLE S20E 19.00'

ABOUT 1993

GEORGE J. AVENDT  
FD. 1/2" IR CAP 23514  
REPLACED WITH T-IRON  
NO WITNESSES LISTED

B. Description of corner evidence found and/or method applied in restoring or reestablishing corner:

M-6 MAY 1997

- FOUND T-IRON & CAP OVER 1 1/4" PIPE
- 3. 10" YELLOW BIRCH N77W 11.8'+/- NO NAIL FOUND
- 4. 14" MAPLE N62E 24.60 FD. NAIL & CAP 16034
- 7. 26" SOFT MAPLE S26E 18.6'+/- FD. NAIL IN E. FACE
- 8. 15" MAPLE N4E 19.39' FD. NAIL & CAP 16034

Charlevoix Co. Surveyor  
APPROVED  
Signature *Mary C. Kundt*  
Date: 11-13-97

C. Description of monument for corner and accessories established to perpetuate locating the position of the corner:

M-6

- T-IRON AND 1 1/4" PIPE REPLACED WITH CONCRETE CHARLEVOIX COUNTY
  - 3. 10" YELLOW BIRCH N77W 11.82' SET NAIL & TAG
  - 4. 14" MAPLE N62E 24.60' NAIL & CAP 16034
  - 7. 26" SOFT MAPLE S76E 18.64' SET NAIL & TAG IN W.FACE
  - 8. 15" MAPLE N4E 19.39. NAIL & CAP 16034
- AND IS ACCEPTED AS A CAREFUL & FAITHFUL REESTABLISHMENT OF THE POSITION OF THE ORIGINAL CORNER

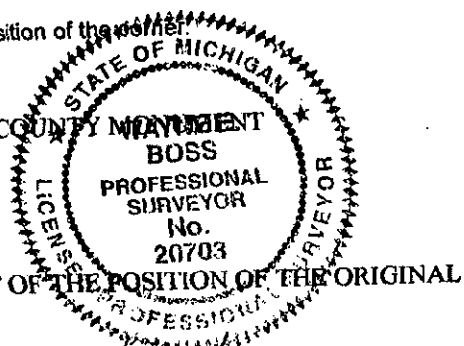

Signed by

Surveyor's Michigan License No. 20703

Date

12/12/97