

SURVEY & REMONUMENTATION

JAN 26 1998

SECTION

LAND CORNER RECORDATION CERTIFICATE
Filing Requirement of Act 74, Mich. P.A. 1970

STATE OF MICHIGAN
COUNTY OF CHARLEVOIX
RECEIVED FOR RECORD

97 DEC 15 PM 2:50

Charles M. Boss
REGISTER OF DEEDS

For corners in

Charlevoix

(County)

Located In:

Corner Code #

1. Public Land Survey

T 32NR 7W M-7
T R _____
T 32NR 6W A-7

2. Property Controlling In Section

S T R _____

3. Miscellaneous Property in Sec.

S T R _____

S T R _____

4. Lot No. _____, Recorded Plat _____

5. Private Claims _____

Register of Deeds Stamp & File Number

Wayne E. Boss

I, _____, in a field survey on May 1997, do hereby state that under requirements of P.A. 74, Michigan P.A. of 1970, the corner points mentioned in lines 1 and 2 above were in conformance with regulations and rules therefore as required in the current manual of survey instructions of the United States Department of the Interior, Bureau of Land Management or by a decree of a Court of Law and/or that the corner points mentioned in lines 3, 4 and 5 above were in conformance with the rules of the Michigan Board of Land Surveyors or by a Decree of a Court of Law; established, re-established, monumented, recovered, found as expressed below:

NOTE: Not more than 2 corners, all in the same town and range, may be recorded on this certificate.

	A	B	C	D	E	F	G	H	I	J	K	L	M
1													
2	6		5		4		3		2		1		
3													
4	7		8		9		10		11		12		
5													
6	18		17		16		15		14		13		
7													
8	19		20		21		22		23		24		
9													
10	30		29		28		27		26		25		
11													
12	31		32		33		34		35		36		
13													

A. Description of original monument and accessories and/or subsequent restoration:

M-7 SEP. 3, 1856

E.D. ATWATER, DEPUTY SURVEYOR
SET POST

1. BEECH 5 INCH N30 1/2W 4 LKS
2. MAPLE 8 INCH S56 3/4W 14 LKS
3. OLD POST 32.7 LINKS NORTH & 12.7 LINKS EAST

ABOUT 1974

MARY C. FEINDT

- FOUND 3/4" BAR ORIGIN UNKNOWN
4. 7" MAPLE N15E 13.50'
 5. 4" MAPLE N65W 14.60'
 6. 15" POPLAR S20E 15.62'

ABOUT 1986

GEORGE J. AVENDT

- FD. 3/4" BAR
PLACED T-IRON ALONG SIDE
NO WITNESSES NOTED

B. Description of corner evidence found and/or method applied in restoring or reestablishing corner:

M-7 NOV. 1996

- FD. 3/4" BAR & T-IRON
4. 7" MAPLE N15E 13.50'
 5. 4" MAPLE N70W 14.50'
 6. 15" POPLAR N30W 15.82'
 7. 8" POPLAR S20E 6.85'

FOUND REMAINS OF FENCE TO EAST & WEST

Charlevoix Co. Surveyor

APPROVED

Signature *Mary C. Feindt*

Date: 11/13/97

C. Description of monument for corner and accessories established to perpetuate locating the position of the corner:

M-7

3/4" BAR & T-IRON WERE REPLACED WITH CONCRETE CHARLEVOIX COUNTY MARKER
4. 7" MAPLE N15W 13.50'
5. 4" MAPLE N70W 14.50'
6. 15" POPLAR S20E 15.85'
7. 8" POPLAR N30W 6.85'
AND IS ACCEPTED AS A CAREFUL & FAITHFUL REESTABLISHMENT OF THE POSITION OF THE ORIGINAL CORNER

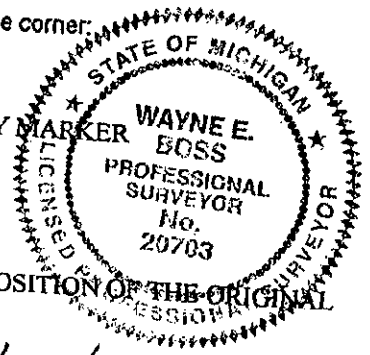

Signed by *[Signature]*
Surveyor's Michigan License No. 20703

Date 12/12/97