

SURVEY & REMONUMENTATION

STATE OF MICHIGAN
COUNTY OF CHARLEVOIX
RECEIVED

98 SEP 15 AM 10:04

OCT 19 1998 LAND CORNER RECORDATION CERTIFICATE
Filing Requirement of Act 74, Mich. P.A. 1970

Charlene A. Barber
REGISTER OF DEEDS

For corners in Charlevoix (County) SECTION _____ Located in: _____ Corner Code # _____

1. Public Land Survey T 32N 7W MC E. OF B-13 #24
T R
T 31N 7W MC E. OF B-1 ANTRIM
T R

2. Property Controlling in Section S T R
S T R

3. Miscellaneous Property in Sec. S T R
S T R

4. Lot No. _____, Recorded Plat _____

5. Private Claims _____

Register of Deeds Stamp & File Number

	A	B	C	D	E	F	G	H	I	J	K	L	M
1													
2	6	5	4	3	2	1							
3													
4	7	8	9	10	11	12							
5													
6	10	17	16	15	14	13							
7													
8	19	20	21	22	23	24							
9													
10	30	29	28	27	26	25							
11													
12	31	32	33	34	35	36							
13													

I, Wayne E. Boss, in a field survey on June, 19 98 do hereby state that under requirements of P.A. 74, Michigan P.A. of 1970, the corner points mentioned in lines 1 and 2 above were in conformance with regulations and rules therefore as required in the current manual of survey instructions of the United States Department of the Interior, Bureau of Land Management or by a decree of a Court of Law and /or that the corner points mentioned in lines 3, 4 and 5 above were in conformance with the rules of the Michigan Board of Land Surveyors or by a Decree of a Court of Law; established, re-established, monumented, recovered, found as expressed below:

NOTE: Not more than 2 corners, all in the same town and range, may be recorded on this certificate.

A. Description of original monument and accessories and/or subsequent restoration:

MEANDER CORNER EAST OF B-13 SEPTEMBER 1954
OCTOBER 24, 1856 A. LESTER DRAGOO, P.S.
EDWARD D. ATWATER, DEPUTY SURVEYOR FOUND WITNESS STUMPS
SET POST WEST SIDE OF LAKE PLACED CONCRETE MONUMENT
HEMLOCK 16 INCH N53 3/4*W 28 LINKS FOR CORNER OF LINCOLN WOODS PLAT AS
HEMLOCK 24 INCH S39 3/4*W 31 LINKS RECORDED IN ANTRIM COUNTY REGISTER OF DEEDS
LIBER 2, PAGE 81, DATED SEPTEMBER 10. 1954.

B. Description of corner evidence found and/or method applied in restoring or reestablishing corner:

MEANDER CORNER EAST OF B-13
FEB. 19, 1998 FOUND CONCRETE MONUMENT NEXT TO SMALL CREEK
5" MAPLE S11*E 6.83' TO CENTER FOUND NAIL IN NORTH FACE
10" STUMP S80*W 12.67 TO CENTER FOUND NAIL IN EAST FACE
12" POPLAR STUMP N50*W 2.83' TO CENTER FOUND NAIL SE FACE
10" POPLAR STUMP 01*E 8.33' TO CENTER FOUND NAIL SOUTH FACE
10" BASSWOOD N40*E 26.85' TO CENTER FOUND BLAZE SW FACE
93'+/- FROM WEST EDGE OF LAKE
B-13 TO MEANDER CORNER GLO 23.72 CHAINS (1565.52') MEASURES 1493.03'
NO EVIDENCE OF OLD CORNER FOUND

Charlevoix Co. Surveyor
APPROVED
Signature *Mary C. Ferrell*
Date: *Aug. 13, 1998*

C. Description of monument for corner and accessories established to perpetuate locating the position of the corner:

MEANDER CORNER EAST OF B13 CONCRETE MONUMENT AS FOUND
5" MAPLE S11*E 6.83 SET NAIL & TAG
10" STUMP S80*W 12.67' TO CENTER
12" POPLAR STUMP N50*W 2.83' TO CENTER
10" POPLAR STUMP N01*E 8.33 TO CENTER
10" BASSWOOD N40*E 26.85' SET NAIL & TAG
18" HEMLOCK N75*E 58.62' SET NAIL & TAG

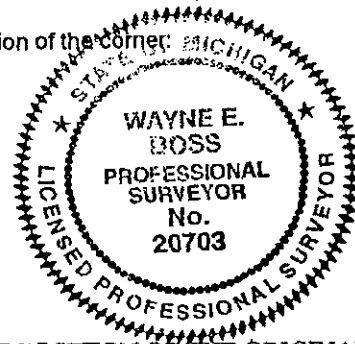

AND IS ACCEPTED AS A CAREFUL & FAITHFUL REESTABLISHMENT OF THE POSITION OF THE ORIGINAL CORNER

Signed by *Wayne E. Boss*
Surveyor's Michigan License No. 20703

Date Aug. 24, 1998