

NOV 21 1997

COMMISSION

LAND CORNER RECORDATION CERTIFICATE
Filing Requirement of Act 74, Mich. P.A. 1970

STATE OF MICHIGAN
COUNTY OF CHARLEVOIX
RECEIVED FOR RECORD

97 JAN -9 PM 3:36

Charlene J. Cochran
REGISTER OF DEEDS

For corners in
Charlevoix
(County)

Located In: Corner Code #

1. Public Land Survey	T 32N R 7W	M-4
	T 32N R 6W	A-4
	T R	
	T R	
2. Property Controlling in Section	S T R	
	S T R	
3. Miscellaneous Property in Sec.	S T R	
	S T R	

Register of Deeds Stamp & File Number

4. Lot No. _____, Recorded Plat _____
5. Private Claims _____

I, Wayne E. Boss, in a field survey on OCTOBER 24, 19 96, do hereby certify that under requirements of P.A. 74, Michigan P.A. of 1970, the corner points mentioned in lines 1 and 2 above were in conformance with regulations and rules therefore as required in the current manual of survey instructions of the United States Department of the Interior, Bureau of Land Management or by a decree of a Court of Law and/or that the corner points mentioned in lines 3, 4 and 5 above were in conformance with the rules of the Michigan Board of Land Surveyors or by a Decree of a Court of Law; established, re-established, monumented, re-monumented, recovered, found as expressed below:

A	B	C	D	E	F	G	H	I	J	K	L	M
2	6	5	4	3	2	1						
3												
4	7	8	9	10	11	12						
5												
6	18	17	16	15	14	13						
7												
8	19	20	21	22	23	24						
9												
10	30	29	28	27	26	25						
11												
12	31	32	33	34	35	36						

NOTE: Not more than 4 corners, all in the same town and range, may be recorded on this certificate.

A. Description of original monument and accessories and/or subsequent restoration:

- M-4 GLO SEPT. 1856 THAT HE REPLACED COR. DID NOT RE-WIT. USED SET QR. SEC. CORNER AGAIN IN JUNE 1891 SURV. NO NEW WIT.(BK 20 & 40)
- 1. BEECH 6 N40 1/2 W 19 LKS.
- 2. BEECH 10 S37 3/4 E 20 LKS.
- E.A. ROBINSON APRIL 1913 FD. 1/4 POST & RESET WITH FD. OLD COR. WITH OLD BRG. 1" X 36" IRON PIPE. TREES DOWN. DID NOT SAY
- 3. SUGAR 4" N73E 53 1/2 CTR.
- 4. SUGAR 6" WEST 111 TO CTR. (WILSON BK.)
- W.BOSS DEC. 1976 FD. 2" PIPE SET BY UNKNOWN. RAISED WITH 1/2 "BAR.
- 5. N80E 35.85' 30" MAPLE
- 6. S40W 58.85' 6" BASSWOOD
- 7. S85W 47.86' 12" BASSWOOD USED IN SUBSEQUENT SURVEYS BY JOHN FERGUSON & CHX. ABST. & ENG.

B. Description of corner evidence found and/or method applied in restoring or reestablishing corner:

- M-4 1/2" IR. FD. W.BOSS WIT. TREES FD. BUT NO SPIKES. CENTER OF TREES FIT CORNER LOCATION. NEW WIT. SPIKES SET BY UNKNOWN.
- 5. N80E 30" MAPLE NEW SPIKE FD. 34.72' (W.B. 35.85')
- 6. S40W 12" BASSWOOD NEW SPIKE FD. 58.26'
- 7. S85W 16" BASSWOOD 47.8' TO CTR. TREE
- 8. WEST 18" BASSWOOD 44.84'
- 9. N30E 36" MAPLE 67.14'

Charlevoix Co. Surveyor
APPROVED
Signature Mary C. Fernald
Date: Jan 9, 1997

C. Description of monument for corner and accessories established to perpetuate locating the position of the corner:

- M-4 & A-4 M-4 T32N-R7W COMMON CORNER TO A-4 T32N-R6W CHARLEVOIX CO. MON. SET
- 5. N80E 30" MAPLE NEW SPIKE FD. 34.72' (W.B. 35.85')
- 6. S40W 12" BASSWOOD NEW SPIKE FD. 58.26'
- 7. S85W 16" BASSWOOD 47.8' TO CTR. TREE
- 8. WEST 18" BASSWOOD 44.84'
- 9. N30E 36" MAPLE 67.14'

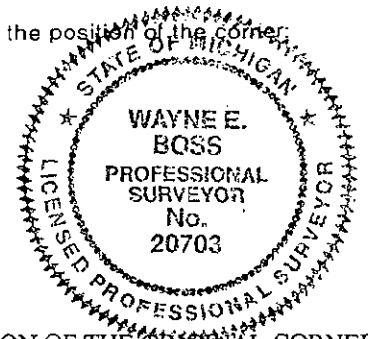

AND IS ACCEPTED AS THE BEST AVAILABLE EVIDENCE OF THE POSITION OF THE ORIGINAL CORNER.,

Signed by Wayne E. Boss Date 11/29/96

Surveyor's Michigan License No. 20703 LIBER 003 PAGE 92