

REMONUMENTATION

NOV 21 1997

COMMISSION

LAND CORNER RECORDATION CERTIFICATE

STATE OF MICHIGAN
COUNTY OF CHARLEVOIX
RECORDED

97 JAN -9 PM 3:37

Filing Requirement of Act 74, Mich. P.A. 1970

Charlene M. Probert
REGISTER OF DEEDS

For corners in
Charlevoix

(County)

Located In:

Corner Code ##

| | | | |
|------------------------------------|-------|------|-----|
| 1. Public Land Survey | T 32N | R 7W | M-5 |
| | T 32N | R 6W | A-5 |
| | T | R | |
| | T | R | |
| 2. Property Controlling in Section | S | T | R |
| | S | T | R |
| 3. Miscellaneous Property in Sec. | S | T | R |
| | S | T | R |

Register of Deeds Stamp & File Number

4. Lot No. _____, Recorded Plat _____
5. Private Claims _____

I, Wayne E. Boss, in a field survey on OCTOBER 24, 1996, do hereby certify that under requirements of P.A. 74, Michigan P.A. of 1970, the corner points mentioned in lines 1 and 2 above were in conformance with regulations and rules therefore as required in the current manual of survey instructions of the United States Department of the Interior, Bureau of Land Management or by a decree of a Court of Law and/or that the corner points mentioned in lines 3, 4 and 5 above were in conformance with the rules of the Michigan Board of Land Surveyors or by a Decree of a Court of Law; established, re-established, monumented, re-monumented, recovered, found as expressed below:

NOTE: Not more than 4 corners, all in the same town and range, may be recorded on this certificate.

A. Description of original monument and accessories and/or subsequent restoration:

M-5 GLO SEPT. 1856
E.D. ATWATER
SET CORNER OF SECT. 12 & 13
1. SUGAR 12 N60W 53 LKS.
2. BEECH 8 S62W 15 LKS.

E.K. ROBINSON FD. & USED
COR. POST IN MAY 1886
SURVEY. NO NEW WIT

E.A. ROBINSON APRIL 1913
FD. COR. REPLACED WITH
3/4" X 30" PIPE
3. BEECH 12 N73E 30 LKS

W.BOSS IN NOV. 1973 FD. 1/2"
REINF. IRON SET BY UNKNOWN
4. 8" MAPLE N53W 61.01'
5. 18" MAPLE NORTH 70.20'
6. 1/2" IR. SOUTH 33.0'
B.JONES RESET COR. FROM WIT
AND ADDED 1 WIT.
7. 10" POPLAR S40E 17.24'

B. Description of corner evidence found and/or method applied in restoring or reestablishing corner:

M-5 1/2" IR. FD. LOCATION REESTABLISHED BY BERYL JONES FROM WIT.
4. 8" MAPLE N53W 61.01'
5. 18" MAPLE (ACTUALLY A BEECH) NORTH 70.20'
6. 1/2" IR. SOUTH 33.0'
7. 10" POPLAR S40E 17.24'

C. Description of monument for corner and accessories established to perpetuate locating the position of the corner:

M-5 & A-5 M-5 T32N-R7W COMMON CORNER TO A-5 T32N-R6W.
CHARLEVOIX CO. MON. SET
4. 8" MAPLE N53W 61.01'
5. 18" MAPLE (ACTUALLY A BEECH) NORTH 70.20'
6. 1/2" IR. SOUTH 33.0'
7. 10" POPLAR S40E 17.24'

AND IS ACCEPTED AS THE BEST AVAILABLE EVIDENCE OF THE POSITION OF THE ORIGINAL CORNER.

Charlevoix Co. Surveyor
APPROVED
Signature: Mary C. Fennell
Date: Jan. 9, 1997

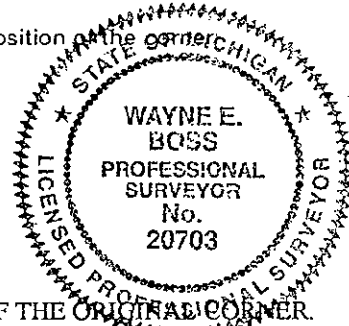

Signed by *Wayne E. Boss* Date 11/29/96

Surveyor's Michigan License No. 20703

LIBER 003 PAGE 93