

SURVEY & REMONUMENTATION

JAN 26 1998

SECTION

LAND CORNER RECORDATION CERTIFICATE
Filing Requirement of Act 74, Mich. P.A. 1970

STATE OF MICHIGAN
COUNTY OF CHARLEVOIX
RECEIVED FOR RECORD

97 DEC 15 PM 2:56

Charles M. Parker
REGISTER OF DEEDS

For corners in
Charlevoix
(County)

Located In: Corner Code #

1. Public Land Survey

T	32N	R	7W	M-12
T	32N	R	6W	A-12
T		R		
S		T		
S		T		
S		T		
S		T		

2. Property Controlling in Section

3. Miscellaneous Property in Sec.

4. Lot No. _____, Recorded Plat _____
5. Private Claims _____

Wayne E. Boss May 97

in a field survey on _____, 19____ do hereby state that under requirements of P.A. 74, Michigan P.A. of 1970, the corner points mentioned in lines 1 and 2 above were in conformance with regulations and rules therefore as required in the current manual of survey instructions of the United States Department of the Interior, Bureau of Land Management or by a decree of a Court of Law and /or that the corner points mentioned in lines 3, 4 and 5 above were in conformance with the rules of the Michigan Board of Land Surveyors or by a Decree of a Court of Law; established, re-established, monumented, discovered, found as expressed below:

NOTE: Not more than 2 corners, all in the same town and range, may be recorded on this certificate.

Register of Deeds Stamp & File Number

	A	B	C	D	E	F	G	H	I	J	K	L	M
1													
2	6		5		4		3		2		1		
3													
4	7		8		9		10		11		12		
5													
6	18		17		16		15		14		13		
7													
8	19		20		21		22		23		24		
9													
10	30		29		28		27		26		25		
11													
12	31		32		33		34		35		36		
13													

A. Description of original monument and accessories and/or subsequent restoration:

- | | | |
|---|---|---|
| M-12 OCTOBER 1856
E.D. ATWATER, DEPUTY SURVEYOR
SET POST
1. ELLM 26 INCH N85E 17 LKS.
2. SUGAR 10 INCH S72 1/4E 43 LKS. | AUG. 31, 1905
E.A. ROBINSON COUNTY SURVEYOR
FD. 1/4 POST ROTTEN
NO OLD WITNESSES FOUND
SET 1 1/4" X 18" GAL. IRON PIPE
3. SUGAR 10" S51E 55 1/2 LNKS.
4. GREY ELM 6" N88 3/4 W 79 LNKS. | JUNE 22, 1993
NICHOLAS B. DEYOUNG, P.S.
FOUND 1 1/2" PIPE
5. POWER POLE S35E 93.40'
6. 18" MAPLE WEST 45.45'
7. 30" MAPLE S33W 65.08'
8. 25" MAPLE 25W 87.30' |
|---|---|---|

B. Description of corner evidence found and/or method applied in restoring or reestablishing corner:

- M-12 NOVEMBER 1996
FOUND 2" PIPE OVER 1 1/2" PIPE
5. POWER POLE S35E 93.54' FD. NAIL & TAG 20705
6. 18" MAPLE WEST 45.42' FD. NAIL & TAG 20705
7. 30" MAPLE S33W 65.14' FD. NAIL & TAG 20705
8. 25" MAPLE S25W 87.35' FD. NAIL & TAG 20705

Charlevoix Co. Surveyor
APPROVED
Signature *Mary C. Fenwick*
Date: 11/13/97

GLO M-12 TO M-13 2640 MEASURE 2624.98'
GLO M-12 TO M-11 2640 MEASURE 2633.17'

C. Description of monument for corner and accessories established to perpetuate locating the position of the corner:

- M-12 2" PIPE REPLACED WITH STEEL CHARLEVOIX COUNTY MARKER
5. POWER POLE S35E 93.54' NAIL & TAG 20705
6. 18" MAPLE WEST 45.42' NAIL & TAG 20705
7. 30" MAPLE S33W 65.14' NAIL & TAG 20705
8. 25" MAPLE S25W 87.35' NAIL & TAG 20705
9. 32" MAPLE N20E 79.80' SET NAIL & TAG 20703
AND IS ACCEPTED AS A CAREFUL & FAITHFUL REESTABLISHMENT OF THE POSITION OF THE ORIGINAL CORNER

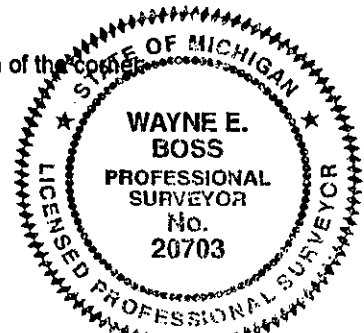

Signed by *Wayne E. Boss*
Surveyor's Michigan License No. 20703

Date 12/12/97