

SURVEY & REMONUMENTATION

JAN 26 1998

SECTION

LAND CORNER RECORDATION CERTIFICATE
Filing Requirement of Act 74, Mich. P.A. 1970

STATE OF MICHIGAN
COUNTY OF CHARLEVOIX
RECEIVED FOR RECORD

97 DEC 16 AM 10:21

Charlene M. Casler
REGISTER OF DEEDS

For corners in

<u>CHARLEVOIX</u> (County)	Located In:	Corner Code #
1. Public Land Survey	<u>T 32NR 6W</u>	<u>E-1</u>
	T ___ R ___	_____
	T ___ R ___	_____
	T ___ R ___	_____
2. Property Controlling in Section	S ___ T ___ R ___	_____
	S ___ T ___ R ___	_____
3. Miscellaneous Property in Sec.	S ___ T ___ R ___	_____
	S ___ T ___ R ___	_____

Register of Deeds Stamp & File Number

4. Lot No. _____, Recorded Plat _____
5. Private Claims _____

I, ARTHUR R. RANGER, in a field survey on SEPT. 15, 1997 do hereby state that under requirements of P.A. 74, Michigan P.A. of 1970, the corner points mentioned in lines 1 and 2 above were in conformance with regulations and rules therefore as required in the current manual of survey instructions of the United States Department of the Interior, Bureau of Land Management or by a decree of a Court of Law and /or that the corner points mentioned in lines 3, 4 and 5 above were in conformance with the rules of the Michigan Board of Land Surveyors or by a Decree of a Court of Law; established, re-established, monumented, recovered, found as expressed below:

NOTE: Not more than 2 corners, all in the same town and range, may be recorded on this certificate.

A	B	C	D	E	F	G	H	I	J	K	L	M
1												
2	6		5		4		3		2		1	
3												
4	7		8		9		10		11		12	
5												
6	18		17		16		15		14		13	
7												
8	19		20		21		22		23		24	
9												
10	30		29		28		27		26		25	
11												
12	31		32		33		34		35		36	
13												

A. Description of original monument and accessories and/or subsequent restoration:

- E-1 corner common to Sec.'s 4 & 5 of T.32N., R.6W.
- 1856-E. D. Atwater set the closing corner and witnessed: Beech 12" S17.25°W 32 lks; Beech 11" S28.50°E 53 lks.--Note: The new corner fell 468 lks West of the corner between Sec.'s 32 & 33 Of T.33N., R.6W.
- 1880-E.K. Robinson references the corner in his survey in Sec. 4, T.32N., R.6W.
- 1881-E.K. Robinson found the gov't corner and witnesses in his survey in Sec. 32, T.33N., R.6W.--witnesses are the same as above.
- 1973-Charlevoix Abstract sketch of town line--corner was out at this time.
- 1977-Larry Feindt found a fence iron used by Nick DeYoung and witnessed: 3-10" Elm South 12.0'; 8" Maple East 2.20'; 4" Maple N15°W 1.50'; 4" Maple West 9.45'
- 1980-Danny Bongiovanni found the fence iron and witnessed: 5" Maple West 19.43'; 4" Maple N45°W 1.73'; 7" Maple N80°E 2.46'; 3" Cedar N40°W 12.65'; 10" Pop. N70°E 44.76'; 2-6" Y. Birch N85°E 33.60'
- 1980-Danny Bongiovanni found the fence iron in a survey in Sec. 5, T.32N., R.6W.--same witnesses as above.
- 1986-John Ferguson found the fence iron and used in a survey in the S.W.1/4 of Sec. 4, T.32N., R.6W. Witnesses: 10" Elms South 12.0'; 8" Maple East 2.20'
- 199_-Sherm Chamberlain found the above corner to be erroneous! The fence iron did not match the deflection in the Town line that Robinson Showed in his old survey notes of Sec. 32, T.33N., R.6W.--Sherm set a 1/2" rod based on Robinson's work in Sec. 32.
- 199_-Sherm Chamberlain used the 1/2" rod in a survey to the North.
- 1994-John Ferguson found the 1/2" rod and witnessed: 7" Maple S69°W 52.76'; 16" Maple N73°W 74.84'; 16" Maple N39°E 32.65'; Steel fence post N15°E 23.09'

B. Description of corner evidence found and/or method applied in restoring or reestablishing corner:

- E-1 corner common to Sec.'s 4 & 5 of T.32N., R.6W.
- 1997-Arthur R. Ranger found the fence iron and the 1/2" rod and witnesses; The 1/2" rod set by Chamberlain seemed to match the old Robinson Notes better that the fence iron. The 1/2" iron rod matches the local road occupation much better also.

C. Description of monument for corner and accessories established to perpetuate locating the position of the corner:

- E-1 corner common to Sec.'s 4 & 5 of T.32N., R.6W.
- (Set a Charlevoix County Marker)
- 8" Maple N24°E 24.15'
- 16" Maple S21°E 67.00'
- 6" tw. Maple N64°W 30.40'
- 6" Maple N33°W 16.98'
- Steel fence post N15°E 23.09'

Charlevoix Co. Surveyor
APPROVED
Signature *Arthur R. Ranger*
Date: 12-16-97

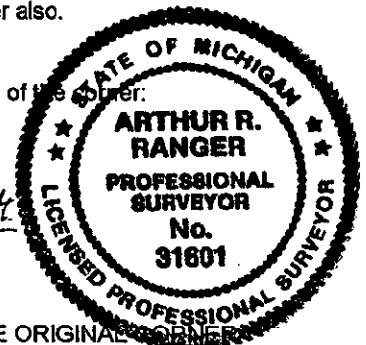

AND IS ACCEPTED AS A CAREFUL AND FAITHFUL PERPETUATION OF THE POSITION OF THE ORIGINAL CORNER

Signed by *Arthur R. Ranger*
Surveyor's Michigan License No. 31601

Date 12/09/97