

**SURVEY &  
RECORD DOCUMENTATION**

OCT 18 1996

COMMISSION

STATE OF MICHIGAN  
COUNTY OF CHARLEVOIX  
RECEIVED FOR RECORD

96 OCT 10 AM 11:30

**LAND CORNER RECORDATION CERTIFICATE  
Filing Requirement of Act 74, Mich. P.A. 1970**

*Charlene M. Cook*  
REGISTER OF DEEDS

For corners in

<u>CHARLEVOIX</u> (County)	Located In:	Corner Code #
1. Public Land Survey	T <u>32NR 6W</u>	<u>G-13</u>
	T <u>31NR 6W</u>	<u>G-1</u>
	T ___ R ___	_____
	T ___ R ___	_____
2. Property Controlling In Section	S ___ T ___ R ___	_____
	S ___ T ___ R ___	_____
3. Miscellaneous Property in Sec.	S ___ T ___ R ___	_____
	S ___ T ___ R ___	_____

Register of Deeds Stamp & File Number

4. Lot No. \_\_\_\_\_, Recorded Plat \_\_\_\_\_  
5. Private Claims \_\_\_\_\_

I, Arthur R. Ranger, in a field survey on May 18, 1995 do hereby state that under requirements of P.A. 74, Michigan P.A. of 1970, the corner points mentioned in lines 1 and 2 above were in conformance with regulations and rules therefore as required in the current manual of survey instructions of the United States Department of the Interior, Bureau of Land Management or by a decree of a Court of Law and /or that the corner points mentioned in lines 3, 4 and 5 above were in conformance with the rules of the Michigan Board of Land Surveyors or by a Decree of a Court of Law; established, re-established, monumented, recovered, found as expressed below:

	A	B	C	D	E	F	G	H	I	J	K	L	M
1													
2		6		5		4		3		2		1	
3													
4		7		8		9		10		11		12	
5													
6		18		17		16		15		14		13	
7													
8		19		20		21		22		23		24	
9													
10		30		29		28		27		26		25	
11													
12		31		32		33		34		35		36	
13													

NOTE: Not more than 2 corners, all in the same town and range, may be recorded on this certificate.

A. Description of original monument and accessories and/or subsequent restoration:

G-13 corner common to Sections 33 & 34, T.32N-R.6W & Sections 3 & 4, T.31N-R.6W  
1856- E.D. Atwater set the new corner in his Resurvey and witnessed: Hemlock 12" N57°E 31 lks.; Lynn 7" N31.5°W 54 lks.  
18\_\_ E.K. Robinson set new witnesses to the corner: Beech 20" N58.5°W 42.25 lks.; Sugar Shade 6" N39°E 129 lks.

B. Description of corner evidence found and/or method applied in restoring or reestablishing corner:

G-13 corner common to Sections 33 & 34, T.32N-R.6W & Sections 3 & 4, T.31N-R.6W  
1995- Arthur R. Ranger, surveyor found a bent t-iron stake at the intersection of roads N.,S., E. & W. Old notes refer to county surveyors surveying for roads in Sec. 33.

C. Description of monument for corner and accessories established to perpetuate locating the position of the corner:

G-13 corner common to Sections 33 & 34, T.32N-R.6W & Sections 3 & 4, T.31N-R.6W  
Replaced with a Harrison Monument  
Fe. Post S46°E 48.16'  
Fe. Post S60°W 65.07'  
Fe. Post N64°W 85.95'  
Fe. Post N40°E 46.91'

Charlevoix Co. Surveyor  
APPROVED  
Signature *Mary C. Ferrell*  
Date: October 10, 1996

The collateral evidence is strictly local in nature, and is accepted as the best available evidence of the position of the original corner.

Signed by Arthur R. Ranger Date 10/09/96  
Surveyor's Michigan License No. 31601

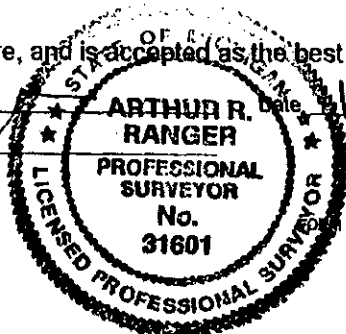

APPROVED BY MICHIGAN STATE BOARD OF PROFESSIONAL SURVEYORS, JAN. 28, 1971  
REVISED MAY 14, 1975  
REVISED JAN., 1983  
REVISED OCT., 1996