

SURVEY & REMONUMENTATION

FEB 22 2001

STATE OF MICHIGAN
COUNTY OF CHARLEVOIX
REGISTERED FOR RECORD

96 DEC 11 PM 3:11

SECTION

LAND CORNER RECORDATION CERTIFICATE
Filing Requirement of Act 74, Mich. P.A. 1970

Charles M. Chamberlain
REGISTER OF DEEDS

For corners in
Charlevoix

(County)

Located In:

Corner Code ##

Public Land Survey

T 32N R 7W
T 32N R 6W
T 33N R 6W
T 33N R 7W

M-1
A-1 ✓
A-13
M-13

Property Controlling
in Section

S ___ T ___ R ___
S ___ T ___ R ___

Miscellaneous
Property in Sec.

S ___ T ___ R ___
S ___ T ___ R ___

Register of Deeds Stamp & File Number

Lot No. _____, Recorded Plat _____

Private Claims _____

	A	B	C	D	E	F	G	H	I	J	K	L	M
2	6	5	4	3	2	1							
3													
4	7	8	9	10	11	12							
5													
6	16	17	16	15	14	13							
7													
8	19	20	21	22	23	24							
9													
10	30	29	28	27	26	25							
11													
12	37	32	33	34	35	36							
13													

Wayne E. Boss in a field survey on OCTOBER 14 19 96

do hereby certify that under requirements of P.A. 74, Michigan P.A. of 1970, the corner points mentioned in lines 1 and 2 above were in conformance with regulations and rules therefore as required in the current manual of survey instructions of the United States Department of the Interior, Bureau of Land Management or by a decree of a Court of Law and/or that the corner points mentioned in lines 3, 4 and 5 above were in conformance with the rules of the Michigan Board of Land Surveyors or by a Decree of a court of Law; established, re-established, monumented, re-monumented, recovered, found as expressed below:

NOTE: Not more than 4 corners, all in the same town and range, may be recorded on this certificate.

Description of original monument and accessories and/or subsequent restoration:

- M-1 GLO JUNE 1839 FD. TWP. COR. 3/4" SOLID ROD SET BY UNKNOWN.
 JOHN HODGSON 1. BEECH 9 N41W 23 LKS. L.FEINDT USED IN 1978 SURVEY AND
 SET POST AT INTER- 3. SUGAR 8 S8E 4 LKS. 1986 SURVEY.
 SECTION COR. TWP. E.K. ROBINSON REUSED COR. 4. N60E 90.0' 20" MAPLE
 32 & 33 N., 6 & 7 W. IN LATER SURVEY. NO DATE 5. N20W 59.0' P.P.
 1. BEECH 7 N35W 23 LKS. GIVEN. ALSO E.K.R. USED 6. WEST 33.0' T-IRON
 2. BEECH 7 S74W 18 LKS. COR. IN 1886
 JUNE 1877 E.K. ROBINSON 1/2" IR. & CAP SET BY J. FERGUSON
 7. PWR. POLE S26E 88.78'(SEE BACK)

Description of corner evidence found and/or method applied in restoring or reestablishing corner:

- M-1 1/2" IRON FOUND WITH CAP(FERGUSON & CHAMBERLAIN). NO DIRECT TIE TO GLO.
 4. N60E 90.0' 28" MAPLE
 6. WEST 32.63' T-IRON FD.
 7.PWR. POLE S26E 88.78'
 8. 12" APPLE S66W 100.30'
 9. TELE. BOX N10W 60.35'
 10. ROAD SIGN N80E 41.26'

Charlevoix Co. Surveyor
APPROVED
Signature *Mary C. Fernald*
Date: *Nov 13, 1996*

Description of monument for corner and accessories established to perpetuate locating the position of the corner:

- M-1 & M-13 TOWNSHIP CORNER COMMON TO M-1 T32N-R7W & M-13 T33NN-R7W & A-1 T32N-R6W & A-13 T33N-R6W.
 CHARLEVOIX CO. MON. SET
 4. N60E 90.2' 28" MAPLE (SPIKE & TAG SET)
 6. WEST 32.63' T-IRON FOUND
 7. S26E 88.78' POWER POLE SPIKE FOUND
 8. 12" APPLE S66W 100.30'
 9. N10W 60.48' CTR. OF TELE. RISER
 10. N70E 24.35' AT SIGN POST
 AND IS ACCEPTED AS THE BEST AVAILABLE EVIDENCE OF THE POSITION OF THE ORIGINAL CORNER.

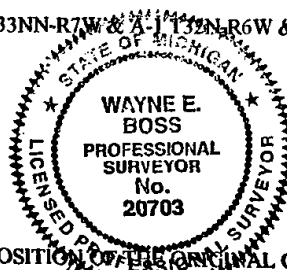

signed by _____ Date 11/27/96
 Surveyor's Michigan License No. 20703 LIBER 003 PAGE 85
 FORM APPROVED BY MICHIGAN STATE BOARD OF LAND SURVEYORS, JAN. 20, 1971
 REVISED MAY 14, 1975
 REVISED JAN., 1983

This should have been entered

SURVEY &
REMONUMENTATION

FEB 22 2001

SECTION

3013

T32N, R6W A-1

A. con't

- 8. 12" APPLE S66W 100.30'
- 9. TELE. BOX N10W 60.35'
- 10. ROAD SIGN N80E 41.26'