

IS IS BEING RERECORDED TO CORRECT THE COUNTY

STATE OF MICHIGAN  
COUNTY OF CHARLEVOIX

Mary C. Feendt 2/13/97

LAND CORNER RECORDATION CERTIFICATE  
Filing Requirement of Act 74, Mich. P.A. 1970

96 DEC 11 PM 2:58

For corners in  
Charlevoix & Antrim  
(County)

Located In: Corner Code #

1. Public Land Survey	T 32N	R 7W	A-1
	T 33N	R 7W	A-13
	T 32N	R 8W	M-1 ANTRIM
	T 33N	R 8W	M-13
2. Property Controlling in Section	S	T	R
	S	T	R
3. Miscellaneous Property in Sec.	S	T	R
	S	T	R

REGISTER OF DEEDS  
RECEIVED FOR RERECORDING  
DATE Feb. 13, 1997 at 11:00 A.M.  
Register of Deeds-Charlevoix Co., MI  
Register of Deeds Stamp & File Number

1. Lot No. \_\_\_\_\_, Recorded Plat \_\_\_\_\_  
2. Private Claims \_\_\_\_\_

A	B	C	D	E	F	G	H	I	J	K	L	M
2	6	5	4	3	2	1						
3												
4	7	8	9	10	11	12						
5												
6	13	17	16	15	14	13						
7												
8	19	20	21	22	23	24						
9												
10	30	29	28	27	26	25						
11												
12	31	32	33	34	35	36						
13												

Wayne E. Boss, In a field survey on OCTOBER 22, 1996, I hereby certify that under requirements of P.A. 74, Michigan P.A. of 1970, the corner points mentioned in lines 1 and 2 above were in conformance with regulations and rules therofore as required in the current manual of survey instructions of the United States Department of the Interior, Bureau of Land Management or by a decree of a Court of Law and/or that the corner points mentioned in lines 3, 4 and 5 above were in conformance with the rules of the Michigan Board of Land Surveyors or by a Decree of a Court of Law; established, re-established, monumented, re-monumented, recovered, found as expressed below:

NOTE: Not more than 4 corners, all in the same town and range, may be recorded on this certificate.

Description of original monument and accessories and/or subsequent restoration:

A-1 GLO JUNE 1839 WILLIAM MILLER OCT. 1883 3/4" PIPE SET BY UNKNOWN  
 JOHN HODGSON FOUND TOWN COR. USED BY JOHN FERGUSON IN  
 SET POST AT INTERSECTION NO NEW WIT. 1978 SURVEY. LCRC L.2 PG. 95  
 CORNER TOWNSHIPS 32 & 33  
 NORTH OF RANGES 7 & 8 WEST  
 1. HEMLOCK 16 N82E 19  
 2. HEMLOCK 12 N11W 28  
 3. 8" BASS N29W 30.5'  
 4. 4" POPLAR N39E 24.25'  
 5. 14" POLAR 5.42E 58.28'  
 6. 6" PINE S45W 70.71'

SURVEY & REMONUMENTATION  
FEB 22 2001  
SECTION

Description of corner evidence found and/or method applied in restoring or reestablishing corner:

A-1 3/4" PIPE FOUND ON A FENCE LINE TO THE NORTH.  
 3. 12" BASSWOOD N29W 30.48'  
 4. 10" POPLAR N39E 23.67'  
 5. 12" POPLAR S35E 57.52'  
 6. 8" PINE S45W 70.35'

GLO TO B-1 2712.6' MEAS. 2679.67'  
 TO A-2 3024.12' MEAS. 3012.05'  
 TO L-13 T32N-R8W 2640' MEAS. 2636.12'  
 TO M-12 T32N-R8W 2640' MEAS. 2666.12'

Charlevoix Co. Surveyor  
APPROVED  
Signature Mary C. Feendt  
Date: Nov. 13, 1996

Description of monument for corner and accessories established to perpetuate locating the position of the corner:

A-1 & A-13 & M-1 & M-13 A-1 T32N-R7W TOWNSHIP CORNER COMMON CORNER A-13 T33N-R7W M-1 T32N-R8W, M-13 T33N-R8W.  
 CHARLEVOIX COUNTY MON SET.  
 3. 12" BASSWOOD N29W 30.48'  
 4. 10" POPLAR N39E 23.67'  
 5. 12" POPLAR S35E 57.52'  
 6. 8" PINE S45W 70.35'

LIBER 003 PAGE 95

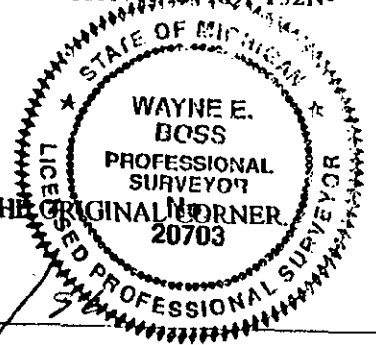

AND IS ACCEPTED AS THE BEST AVAILABLE EVIDENCE OF THE POSITION OF THE ORIGINAL CORNER.  
 Date 11/25/96  
 Surveyor's Michigan License No. 20703

LIBER 003 PAGE 73

This should have been entered in the