

**SURVEY & REMONUMENTATION**

OCT 19 1998

**SECTION**

**LAND CORNER RECORDATION CERTIFICATE**  
Filing Requirement of Act 74, Mich. P.A. 1970

For corners in

Charlevoix

(County)

Located In:

Corner Code #

1. Public Land Survey		<u>74N</u> R <u>8W</u>	<u>K-9</u>
		T <u>    </u> R <u>    </u>	<u>    </u>
		T <u>    </u> R <u>    </u>	<u>    </u>
		T <u>    </u> R <u>    </u>	<u>    </u>
2. Property Controlling In Section	S <u>    </u>	T <u>    </u> R <u>    </u>	<u>    </u>
	S <u>    </u>	T <u>    </u> R <u>    </u>	<u>    </u>
3. Miscellaneous Property in Sec.	S <u>    </u>	T <u>    </u> R <u>    </u>	<u>    </u>
	S <u>    </u>	T <u>    </u> R <u>    </u>	<u>    </u>

STATE OF MICHIGAN  
COUNTY OF CHARLEVOIX  
RECEIVED RECORD

98 SEP -8 PM 2:14

*Charlene M. Feindt*  
REGISTER OF DEEDS

Register of Deeds Stamp & File Number

4. Lot No. \_\_\_\_\_, Recorded Plat \_\_\_\_\_  
5. Private Claims \_\_\_\_\_

A	B	C	D	E	F	G	H	I	J	K	L	M
1												
2	6		5		4		3		2		1	
3												
4	7		8		9		10		11		12	
5												
6	18		17		16		15		14		13	
7												
8	19		20		21		22		23		24	
9												
10	30		29		28		27		26		25	
11												
12	31		32		33		34		35		36	
13												

Wayne E. Boss, in a field survey on JULY, 1998 do hereby state that under requirements of P.A. 74, Michigan P.A. of 1970, the corner points mentioned in lines 1 and 2 above were in conformance with regulations and rules therefore as required in the current manual of survey instructions of the United States Department of the Interior, Bureau of Land Management or by a decree of a Court of Law and /or that the corner points mentioned in lines 3, 4 and 5 above were in conformance with the rules of the Michigan Board of Land Surveyors or by a Decree of a Court of Law; established, re-established, monumented, recovered, found as expressed below:

NOTE: Not more than 2 corners, all in the same town and range, may be recorded on this certificate.

A. Description of original monument and accessories and/or subsequent restoration:

K-9 NOT ESTABLISHED BY GOVERNMENT LAND OFFICE

Charlevoix Co. Surveyor  
**APPROVED**

Signature Mary C. Feindt  
Date: Aug. 13, 1998

B. Description of corner evidence found and/or method applied in restoring or reestablishing corner:

K-9 PLACED CORNER BY EXTENSION AND INTERSECTION OF SOUTH LINE OF SECTION 23 AS DOCUMENTED WEST LINE OF SECTION 24 AS MONUMENTED ON RECORDED SURVEYS PERFORMED BY MARY C. FEINDT FOR THE CITY OF CHARLEVOIX, PRIVATE INDIVIDUALS AND THE ABANDENMENT OF THE FORMER CHSS. & OHIO RAILWAY RIGHT OF WAY.

C. Description of monument for corner and accessories established to perpetuate locating the position of the corner:

K-9 PLACED STEEL CHARLEVOIX COUNTY MARKER  
6" RED PINE N74°E 19.55 SET NAIL & TAG  
8" OAK, EASTERLY TREE OF CLUSTER S10°W 86.34' SET NAIL & TAG  
1/2" IRON S43°W 26.77' CAP 31601  
UTILITY POLE N52°W 41.45' SET NAIL & TAG  
1/2" IRON N01°40'W 88.07' NO CAP  
CONCRETE MONUMENT NO°W 97.25' NO CAP  
J-9 TO K-9 S89°56'04"E 2578.15', K-9 TO K-8 N00°04'39"E 1505.69', K-9 & T-IRON TO SOUTH S00°04'39"W 346.06'  
AND IS ACCEPTED AS A CAREFUL & FAITHFUL ESTABLISHMENT OF THE POSITION OF THE CORNER

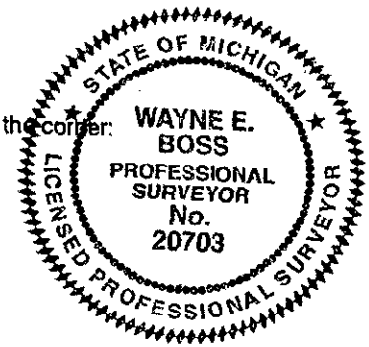

Signed by Wayne E. Boss  
Surveyor's Michigan License No. 20703

Date Aug. 24, 1998