

MICHIGAN
DEPARTMENT OF CONSERVATION
FORESTRY DIVISION

LAND CORNER RECORD

T. 34 N.R. 1 W

Cheboygan COUNTY

DESCRIPTION OF CORNER Sec. corner common to Sections 25-26-35-36

CORNER MONUMENT Set 1" pipe with 4" aluminum cap

DATE MONUMENT PLACED AND WITNESSED Nov. 10, 1966

WITNESSES TO CORNER.....

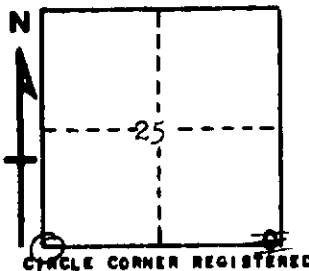

16" W. Pine N 48 W 14.5'

10" Cedar S 25 E 20.5'

AND

DESCRIPTION IN DETAIL AS TO HOW CORNER WAS LOCATED AND IDENTIFIED OR RESTORED.

This corner was restored during a survey in this area. Set this corner from NE USBT which has slab showing notch. This conforms to position noted in earlier Schaaf survey, and one by Buckler in 1950. Good original corner.

SURVEYOR'S SEAL

SIGNED *Kevin J. Ostling* DATE 11-10-66
REGISTERED LAND SURVEYOR #10068