

MICHIGAN
DEPARTMENT OF CONSERVATION
FORESTRY DIVISION

LAND CORNER RECORD

T. 34 N.R. 3 W

Cheboygan COUNTY

DESCRIPTION OF CORNER 1/4 corner common to Sections 27 and 34

CORNER MONUMENT Left 1" iron bar in place

DATE MONUMENT PLACED AND WITNESSED 6/29/61

WITNESSES TO CORNER.....

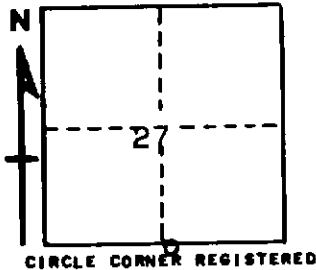

5" Elm - S48W - 30.2 ft

5" Maple - N30E - 43.0 ft

AND

DESCRIPTION IN DETAIL AS TO HOW CORNER WAS LOCATED AND IDENTIFIED OR RESTORED.

This corner was found by Forestry Division survey crew while making a survey in this area. Found a 1" iron stake in center of E-W county road and nearly in line with old fence north. Apparently established in previous survey and was considered acceptable as proper location for corner.

SURVEYOR'S SEAL

SIGNED Kenneth J. Ostling DATE 7/6/61
REGISTERED LAND SURVEYOR