

MICHIGAN  
DEPARTMENT OF CONSERVATION  
FORESTRY DIVISION

# LAND CORNER RECORD

T. 34 N.R. 3 W

Cheboygan COUNTY

DESCRIPTION OF CORNER Section corner common to Sections 27-28-33-34

CORNER MONUMENT Left 3/4" pipe in place

DATE MONUMENT PLACED AND WITNESSED 6/29/61

WITNESSES TO CORNER.....

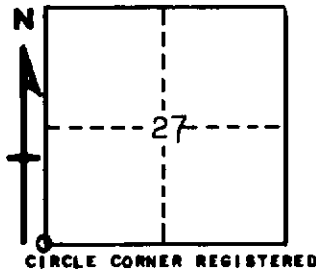

SW cor foundation - N49E - 47.0 ft

Apple tree - S41E - 101.7 ft

AND

DESCRIPTION IN DETAIL AS TO HOW CORNER WAS LOCATED AND IDENTIFIED OR RESTORED.

This corner was found by Forestry Division survey crew while making a survey in this township. Found 3/4" pipe at apparent intersection of centerline of county roads E-W-S and old grade north. Probably used in the survey of other lands in this vicinity and was considered acceptable.

SURVEYOR'S SEAL

SIGNED Kenneth J. Ostling DATE 7/5/61  
REGISTERED LAND SURVEYOR