

MICHIGAN
DEPARTMENT OF CONSERVATION
FORESTRY DIVISION

LAND CORNER RECORD

T. 37 N.R. 1 E.

Cheboygan COUNTY

DESCRIPTION OF CORNER Section corner common to Sections 27 - 28 - 33 - 34

CORNER MONUMENT Set 1" pipe with 4" aluminum cap

DATE MONUMENT PLACED AND WITNESSED December 13, 1963

WITNESSES TO CORNER.....

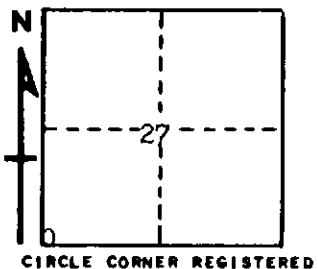

5" Maple N 57 W 8.0'

20" Hemlock S 22 W 45.4

AND

DESCRIPTION IN DETAIL AS TO HOW CORNER WAS LOCATED AND IDENTIFIED OR RESTORED.

This corner was set by proportionate measurement between corners one mile west, two miles east, two miles north and one mile south. Nothing left for U. S. evidence.

SURVEYOR'S SEAL

SIGNED *Kenneth G. Ostberg* DATE December 17, 1963
REGISTERED LAND SURVEYOR # 10,068