

MICHIGAN
DEPARTMENT OF CONSERVATION
FORESTRY DIVISION

LAND CORNER RECORD

T. 37 N.R. 1 E.

Cheboygan COUNTY

DESCRIPTION OF CORNER Witness Meander corner to Sections 34 - 35 on north side lake
approximately 5 chains north of townline.

CORNER MONUMENT Set 1" pipe with 4" aluminum cap

DATE MONUMENT PLACED AND WITNESSED December 16, 1963

WITNESSES TO CORNER.....

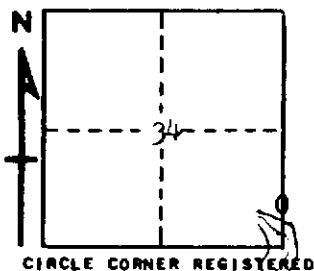

8" R. Oak N 78 E 6.7'

8" R. Oak S 78 W 15.6

AND

DESCRIPTION IN DETAIL AS TO HOW CORNER WAS LOCATED AND IDENTIFIED OR RESTORED.

This corner was set as a witness to the U. S. meander corner which was restored from remains of the U. S. BTs. Both stumps in place with possible evidence of face on both. This area now covered with water and ice and could not locate stake, but we feel this is a restoration of the original corner. Checks okay with original M. C. on town line on south side of Section 35. Placed a wood post in water at proper location for original M. C., and set standard marker as witness corner on section line 75 links north of M. C.

SURVEYOR'S SEAL

SIGNED Kenneth J. Ostling DATE December 30, 1963
REGISTERED LAND SURVEYOR # 16,068