

MICHIGAN  
DEPARTMENT OF CONSERVATION  
FORESTRY DIVISION

# LAND CORNER RECORD

T. 37 N.R. 1E

Cheboygan COUNTY

DESCRIPTION OF CORNER Section corner common to Sections 21 - 22 - 27 - 28

CORNER MONUMENT Set 1" pipe with 4" brass cap.

DATE MONUMENT PLACED AND WITNESSED 8-8-63

WITNESSES TO CORNER.....

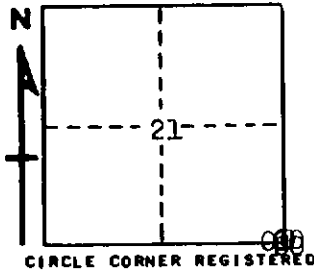

8" R. Pine N 40 E 307.4

AND

**DESCRIPTION IN DETAIL AS TO HOW CORNER WAS LOCATED AND IDENTIFIED OR RESTORED.**

This corner was set by double proportionate measurement between corners 1 mile north, 2 miles south, 1 mile west and 1/2 mile east while making a survey in this township. Can locate no previous corner in open marsh. Checks very well with swamp edges all 4 directions. Good original 1/4 corner 1/2 mile east.

**SURVEYOR'S SEAL**

SIGNED *Ronald H. Helling* #10068 DATE 9-18-63  
REGISTERED LAND SURVEYOR