

CHEBOYGAN COUNTY REMONUMENTATION CORNER

LAND CORNER RECORDATION CERTIFICATE  
Filing Requirement of Act 74, Mich. P.A. 1970

RECEIVED  
FOR RECORD

99 DEC -6 PM 2:48

For corners in

CHEBOYGAN  
(County)

Located In:

Corner Code #

- |                                    |               |                             |             |
|------------------------------------|---------------|-----------------------------|-------------|
| 1. Public Land Survey              |               | <u>T 37NR 2W</u>            | <u>C-7</u>  |
|                                    |               | T <u>    </u> R <u>    </u> | <u>    </u> |
|                                    |               | T <u>    </u> R <u>    </u> | <u>    </u> |
|                                    |               | T <u>    </u> R <u>    </u> | <u>    </u> |
| 2. Property Controlling in Section | S <u>    </u> | T <u>    </u> R <u>    </u> | <u>    </u> |
|                                    | S <u>    </u> | T <u>    </u> R <u>    </u> | <u>    </u> |
| 3. Miscellaneous Property in Sec.  | S <u>    </u> | T <u>    </u> R <u>    </u> | <u>    </u> |
|                                    | S <u>    </u> | T <u>    </u> R <u>    </u> | <u>    </u> |

*Willy Pappas*  
CLERK/REGISTER  
CHEBOYGAN COUNTY MICHIGAN

Register of Deeds Stamp & File Number

4. Lot No. \_\_\_\_\_, Recorded Plat \_\_\_\_\_

5. Private Claims \_\_\_\_\_

A	B	C	D	E	F	G	H	I	J	K	L	M
1												
2	6		5		4		3		2			1
3												
4	7		8		9		10		11			12
5												
6	18		17		16		15		14			13
7												
8	19		20		21		22		23			24
9												
10	30		29		28		27		26			25
11												
12	31		32		33		34		35			36
13												

I, JAMES H. GRANGER, in a field survey on JULY 9, 19 99 do hereby state that under requirements of P.A. 74, Michigan P.A. of 1970, the corner points mentioned in lines 1 and 2 above were in conformance with regulations and rules therefore as required in the current manual of survey instructions of the United States Department of the Interior, Bureau of Land Management or by a decree of a Court of Law and /or that the corner points mentioned in lines 3, 4 and 5 above were in conformance with the rules of the Michigan Board of Land Surveyors or by a Decree of a Court of Law; established, re-established, monumented, recovered, found as expressed below:

NOTE: Not more than 2 corners, all in the same town and range, may be recorded on this certificate.

A. Description of original monument and accessories and/or subsequent restoration:

- |  |                               |           |       |        |
|--|-------------------------------|-----------|-------|--------|
| 1855 GLO Resurvey<br>Harvey Meilen     | Set wood post                 | 12" Beech | S37°E | 14 lks |
|  |                               | 10" Beech | N10°W | 28 lks |
| 1988 LCRC<br>James H. Granger #16041   | Fd ½" pipe<br>set 4 witnesses |           |       |        |
| 1994 Survey<br>James H. Granger #16041 | Fd ½" pipe and witnesses      |           |       |        |

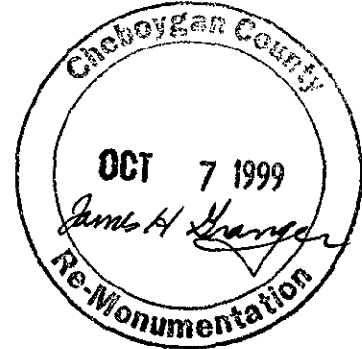

B. Description of corner evidence found and/or method applied in restoring or reestablishing corner:

Found ½" pipe and 3 witnesses per LCRC. Accepted position as established. Replaced ½" pipe with 5/8" rebar

SURVEY &  
RE-MONUMENTATION

MAR 03 2000

SECTION

C. Description of monument for corner and accessories established to perpetuate locating the position of the corner:

- |                                     |       |         |                      |  |
|-------------------------------------|-------|---------|----------------------|--|
| 5/8" rebar with Remonumentation Cap |       |         |                      |  |
| Fence Post                          | S49°W | 62.88'  | Fd nail & tag #16041 |  |
| Fence corner                        | N29°W | 39.80'  | Fd nail & tag #16041 |  |
| 10' Maple                           | S49°E | 85.48'  | Fd nail & tag #16041 |  |
| 10' Maple                           | S29°E | 100.96' | Nail & tag #16041    |  |

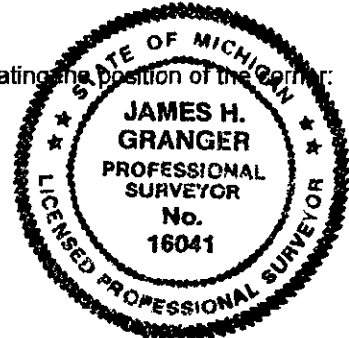

Signed by James H. Granger  
Surveyor's Michigan License No. 16041

Date November 12, 1999