

CHEBOYGAN COUNTY REMONUMENTATION CORNER

LAND CORNER RECORDATION CERTIFICATE
Filing Requirement of Act 74, Mich. P.A. 1970

RECEIVED
FOR RECORD

99 DEC -6 PM 3: 11

For corners in

CHEBOYGAN Located In: Corner Code #
(County)

- 1. Public Land Survey T 37NR 2W 1-9
T R
T R
T R
- 2. Property Controlling S T R
in Section S T R
- 3. Miscellaneous S T R
Property in Sec. S T R

Wibby Pappas
CLERK/REGISTER
CHEBOYGAN COUNTY MICHIGAN

Register of Deeds Stamp & File Number

4. Lot No. _____, Recorded Plat _____

5. Private Claims _____

I, JAMES H. GRANGER, in a field survey on JULY 9, 19 99 do hereby state that under requirements of P.A. 74, Michigan P.A. of 1970, the corner points mentioned in lines 1 and 2 above were in conformance with regulations and rules therefore as required in the current manual of survey instructions of the United States Department of the Interior, Bureau of Land Management or by a decree of a Court of Law and for that the corner points mentioned in lines 3, 4 and 5 above were in conformance with the rules of the Michigan Board of Land Surveyors or by a Decree of a Court of Law; established, re-established, monumented, recovered, found as expressed below:

NOTE: Not more than 2 corners, all in the same town and range, may be recorded on this certificate.

	A	B	C	D	E	F	G	H	I	J	K	L
1												
2	6		5		4		3		2		1	
3												
4	7		8		9		10		11		12	
5												
6	18		17		16		15		14		13	
7												
8	19		20		21		22		23		24	
9												
10	30		29		28		27		26		25	
11												
12	31		32		33		34		35		36	
13												

A. Description of original monument and accessories and/or subsequent restoration:

- 1855 GLO Resurvey Set wood post 24" Beech N45°E 56 lks
Harvey Mellen 10" Beech S15°E 44 lks
- 1947 Unrecorded Survey 1-1/4" axle
Orlando Doyle #7319 No witnesses
- 1952 Unrecorded Survey 4" concrete monument
Orlando Doyle #7319 no witnesses
- 1988 LCRC Fd axle
James H. Granger #16041 set 4 witnesses

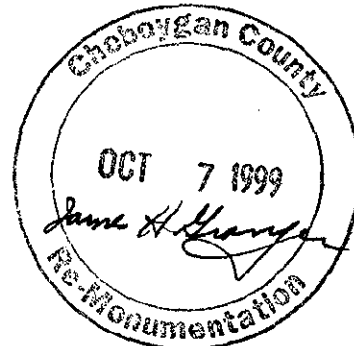

B. Description of corner evidence found and/or method applied in restoring or reestablishing corner:

Found 1/2" iron in Monument Box from Sand Road reconstruction. No LCRC recorded. Found 4 overgrown witnesses per LCRC with nails, next to witnesses, installed by County Road Commission. Accepted position as established. Replaced 1/2" iron with 5/8" rebar.

C. Description of monument for corner and accessories established to perpetuate locating the position of the corner:

- 5/8" rebar with Remonumentation Cap
- 12" Poplar S52°W 49.22' Fd nail
- 19" Poplar N81°W 43.73' Fd nail
- 12" Elm S41°E 72.14' Fd nail
- 10" Poplar N32°E 90.00' Fd nail

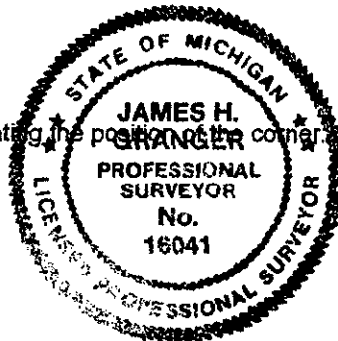

Signed by James H. Granger Date November 12, 1999
Surveyor's Michigan License No. 16041

COPY &
RE...

MAR 03 2000

SECTION