

MAR 22 1999

SECTION

CHEBOYGAN COUNTY  
REMONUMENTATION CORNER

LAND CORNER RECORDATION CERTIFICATE  
Filing Requirement of Act 74, Mich. P.A. 1970

For corners in

<u>CHEBOYGAN</u> (County)	Located In:	Corner Code #
1. Public Land Survey	<u>T 38N R 2W</u>	<u>E-5</u>
	T ___ R ___	_____
	T ___ R ___	_____
	T ___ R ___	_____
2. Property Controlling in Section	S ___ T ___ R ___	_____
	S ___ T ___ R ___	_____
3. Miscellaneous Property in Sec.	S ___ T ___ R ___	_____
	S ___ T ___ R ___	_____

RECEIVED FOR RECORD 12-7-98  
at 9:14 O'Clock A. M

*Joanne Spray*

CLERK/REGISTER  
CHEBOYGAN COUNTY, MICHIGAN

Register of Deeds Stamp & File Number

4. Lot No. \_\_\_\_\_, Recorded Plat \_\_\_\_\_  
5. Private Claims \_\_\_\_\_

A	B	C	D	E	F	G	H	I	J	K	L	M
1												
2	6	5	4	3	2	1						
3												
4	7	8	9	10	11	12						
5												
6	18	17	16	15	14	13						
7												
8	19	20	21	22	23	24						
9												
10	30	29	28	27	26	25						
11												
12	31	32	33	34	35	36						
13												

I, JAMES H. GRANGER, in a field survey on July 15, 1998 do hereby state that under requirements of P.A. 74, Michigan P.A. of 1970, the corner points mentioned in lines 1 and 2 above were in conformance with regulations and rules therefore as required in the current manual of survey instructions of the United States Department of the Interior, Bureau of Land Management or by a decree of a Court of Law and/or that the corner points mentioned in lines 3, 4 and 5 above were in conformance with the rules of the Michigan Board of Land Surveyors or by a Decree of a Court of Law; established, re-established, monumented, recovered, found as expressed below:

NOTE: Not more than 2 corners, all in the same town and range, may be recorded on this certificate.

A. Description of original monument and accessories and/or subsequent restoration:

- 1856 Original survey Harvey Mellen Set Wood Post 6" Cedar N27°E 63 lks 7" Tamarack S11°W 41 lks
- 1966 LCRC Kenneth Larsen #10695 2 witnesses Set 1" pipe with 4" aluminum Cap
- 1986 Survey Norman Quaine #33984 Fd. DNR Monument
- 1990 LCRC Orlando Doyle #7319 1" pipe with 4" aluminum cap
- 1992 Survey James H. Granger #16041 Fd. 1" pipe with 4" cap

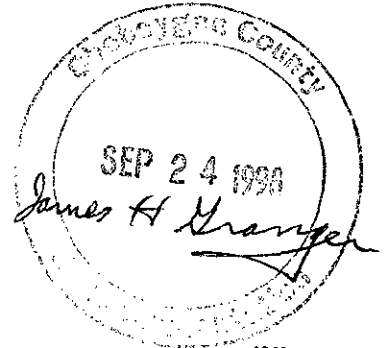

B. Description of corner evidence found and/or method applied in restoring or reestablishing corner:

Fd. 1" pipe w/ 4" aluminum cap.

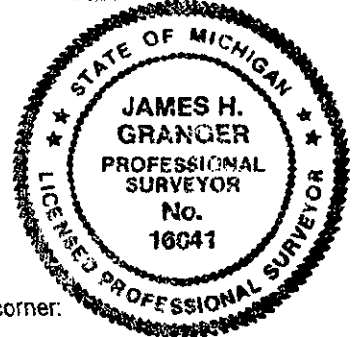

C. Description of monument for corner and accessories established to perpetuate locating the position of the corner:

1" pipe with 4" aluminum cap

- 6" Balsam S21°W 7.00' Set tag #16041
- 7" Balsam S30°W 11.70' Set tag #16041
- 8" Balsam S66°E 13.44' Set tag #16041
- 12" Birch S68°W 6.60' Fd. tag #16041

Signed by James H. Granger Date November 2, 1998 Surveyor's Michigan License No. 16041