

MICHIGAN
DEPARTMENT OF CONSERVATION
FORESTRY DIVISION

LAND CORNER RECORD

T. 38 N.R. 2 W.

Cheboygan COUNTY

DESCRIPTION OF CORNER 1/4 corner common to Sections 19 - 30

CORNER MONUMENT Set 1" pipe with 4" brass cap

DATE MONUMENT PLACED AND WITNESSED May 20, 1963

WITNESSES TO CORNER.....

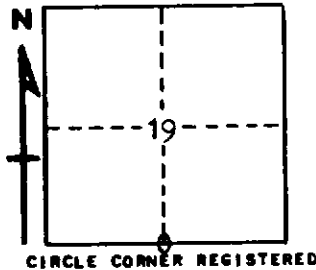

8" Spruce N 72 E 7.9'

12" Spruce N 78 W 10.0'

AND

DESCRIPTION IN DETAIL AS TO HOW CORNER WAS LOCATED AND IDENTIFIED OR RESTORED.

This corner was set by proportionate measurement between section corners while making a retracement in this area. Unable to identify anything for U. S. evidence. Found evidence of possible old stake near corner but could not find bottom. Falls on line prescribed by other corners along this mile.

SURVEYOR'S SEAL

SIGNED *Kenneth J. Ostling* DATE June 24, 1963
REGISTERED LAND SURVEYOR #10068