

MICHIGAN
DEPARTMENT OF CONSERVATION
FORESTRY DIVISION

LAND CORNER RECORD

T. 38 N.R. 3 W.
T. 39 N.R. 3 W.

Cheboygan COUNTY

DESCRIPTION OF CORNER Section corner common to Sections 32 - 33 - 4 - 5

CORNER MONUMENT Set 1" pipe with 4" brass cap

DATE MONUMENT PLACED AND WITNESSED April 22, 1964

WITNESSES TO CORNER.....

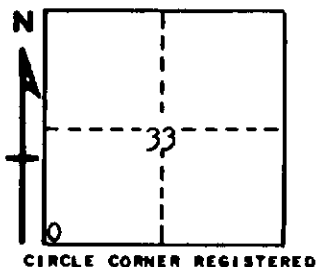

7" Spruce N 13 W 41.5'

8" Balsam S 48 E 23.6'

AND

DESCRIPTION IN DETAIL AS TO HOW CORNER WAS LOCATED AND IDENTIFIED OR RESTORED.

This corner was found while making a survey in this area. Found 2" pipe in place at intersection of old township road grades E - W and S. Appears to have been accepted by surrounding occupation and fits well with original 1/4 corner north.

SURVEYOR'S SEAL

SIGNED *Kenneth J. Ostling* DATE June 18, 1964
REGISTERED LAND SURVEYOR #10068