

MICHIGAN  
DEPARTMENT OF CONSERVATION  
FORESTRY DIVISION

# LAND CORNER RECORD

T.'s  $\frac{38}{37}$  N.R. 24 W

DESCRIPTION OF CORNER Section corner for sections  $\frac{31}{6}$  T38N, R24W Delta COUNTY  
6/5 T37N, R24W  
CORNER MONUMENT T iron buried in approximately  $\frac{1}{2}$  of gravel road  
DATE MONUMENT PLACED AND WITNESSED 9/12/68, F. J. Bray  
WITNESSES TO CORNER..... Telephone pole N 79° W, 27 links

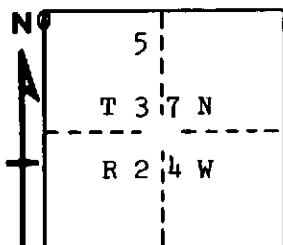

12" apple tree S 41° W, 58 $\frac{1}{2}$  links

AND

CIRCLE CORNER REGISTERED

### DESCRIPTION IN DETAIL AS TO HOW CORNER WAS LOCATED AND IDENTIFIED OR RESTORED.

This corner was rewitnessed as set by M. McNabb in 1918. Fence lines to west and south and in approximately  $\frac{1}{2}$  of north and south road.

SURVEYOR'S SEAL

SIGNED Frank J. Bray DATE 12/4/68  
REGISTERED LAND SURVEYOR  
Frank J. Bray