

MICHIGAN  
DEPARTMENT OF CONSERVATION  
FORESTRY DIVISION

# LAND CORNER RECORD

T. 37 & 38 N.R. 24 W

DESCRIPTION OF CORNER Section corner for sections Delta COUNTY  
T38N R24W 32/33  
T37N R24W 5/4

CORNER MONUMENT 1" iron pipe with 4" aluminum cap

DATE MONUMENT PLACED AND WITNESSED 11/13/68, F. J. Bray

WITNESSES TO CORNER..... 10" Cedar (S.33)(NBT) N 32° E, 34 links

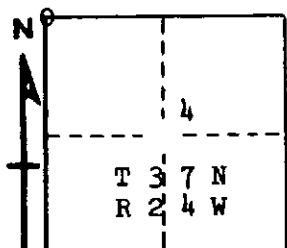

10" Cedar (S. 5)(NBT) S 55° W, 43 links

AND

CIRCLE CORNER REGISTERED

DESCRIPTION IN DETAIL AS TO HOW CORNER WAS LOCATED AND IDENTIFIED OR RESTORED.

This corner was replaced from wood post and points of two older posts. Cedar to NE and tamarack to NW and black ash to SW are stumps in poor condition but check for bearings and distances with original notes. Notch and weathered face on cedar to NE stump bottom in proper position for spruce to SE.

SURVEYOR'S SEAL

SIGNED Frank J. Bray DATE 3/6/69  
REGISTERED LAND SURVEYOR  
Frank J. Bray