

MICHIGAN
DEPARTMENT OF CONSERVATION
FORESTRY DIVISION

LAND CORNER RECORD

T. $\frac{38}{37}$ N.R. 24 W

DESCRIPTION OF CORNER 1/4 corner for sections $\frac{32}{5}$ T38N R24W
T37N R24W Delta COUNTY
CORNER MONUMENT 1" iron pipe with 4" aluminum cap
DATE MONUMENT PLACED AND WITNESSED 12/11/68, F. J. Bray
WITNESSES TO CORNER..... 11" Cedar (1/4S) (NBT) N 50° W, 21½ links

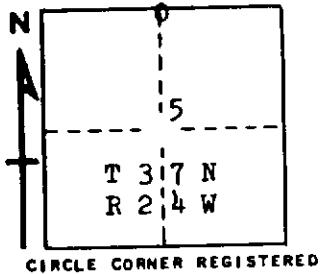

14" W. Pine (1/4 S NBT) N 57° E, 10 links

AND

DESCRIPTION IN DETAIL AS TO HOW CORNER WAS LOCATED AND IDENTIFIED OR RESTORED.

This corner was placed midway and on line between section corners to east and to west. No original evidence found.

SURVEYOR'S SEAL

SIGNED Frank J. Bray DATE 3/6/69
REGISTERED LAND SURVEYOR
Frank J. Bray