

Lansing

CONS. 4047
REV. 10/60

MICHIGAN
DEPARTMENT OF CONSERVATION
FORESTRY DIVISION

LAND CORNER RECORD

T. 40 N. R. 18 W

Delta COUNTY

DESCRIPTION OF CORNER Section corner common to Sections 14, 15, 22, and 23

CORNER MONUMENT 1" Pipe with 4" Brass Cap

DATE MONUMENT PLACED AND WITNESSED 1/18/61 with Bill Wallace and Art Enger.

WITNESSES TO CORNER..... 8" Red Pine (S 23 NBT) S 46° E 14 Links

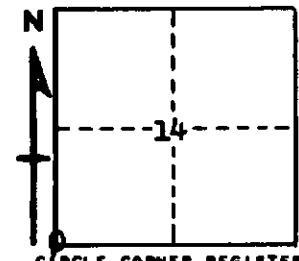

9" Red Pine (S 15 NBT) N 65° W 29½ Links

8" Red Oak (S 14 NBT) N 54° E 53 Links

AND

DESCRIPTION IN DETAIL AS TO HOW CORNER WAS LOCATED AND IDENTIFIED OR RESTORED.

This corner was replaced from one Y. Pine (green) bearing S 26° W, 97 Links and a
F. Pine stump bottom N 40° E, 109 Links. Corner found by Art Enger, Assistant
District Forester.

SURVEYOR'S SEAL

SIGNED Billy D. Buckler DATE 3/20/61
REGISTERED LAND SURVEYOR
Billy D. Buckler