

LAND CORNER RECORDATION CERTIFICATE
Filing Requirement of Act 74, Mich. P.A. 1970

For corners in

Della
(County)

Located in:

Corner Code #

1. Public Land Survey

T 42N R 22W L9
T 42N R 22W L11
T R
T R
S T R
S T R
S T R
S T R

2. Property Controlling In Section

3. Miscellaneous Property in Sec.

Register of Deeds Stamp & File Number

4. Lot No. , Recorded Plat
5. Private Claims

L11 Jul 28 1997
L9 Jul 16 1977

I, Paul R. Bressette, in a field survey on 19 do hereby state that under requirements of P.A. 74, Michigan P.A. of 1970, the corner points mentioned in lines 1 and 2 above were in conformance with regulations and rules therefore as required in the current manual of survey instructions of the United States Department of the Interior, Bureau of Land Management or by a decree of a Court of Law and for that the corner points mentioned in lines 3, 4 and 5 above were in conformance with the rules of the Michigan Board of Land Surveyors or by a Decree of a Court of Law; established, re-established, monumented, recovered, found as expressed below.

NOTE: Not more than 2 corners, all in the same town and range, may be recorded on this certificate.

Grid table with columns A-M and rows 1-13. Contains numbers 1-36 and two dots in the grid.

A. Description of original monument and accessories and/or subsequent restoration:

(L9) Quarter corner common to Sections 24 and 25. 1852: E.C. Martin, D.S. Set wood post witnessed by: Hemlock 10 S75E 17 lks.; Hemlock 8 N87W 22 lks. No record evidence of corner perpetuation or restoration found.
(L11) Quarter corner common to Sections 25 and 36. 1852: E.C. Martin, D.S. Set wood post witnessed by: Spruce 10 S18E 35 lks.; Spruce 12 N41W 26 lks. 1937: U.S. Forest Service. Land corner record by Ray Landiff shows corner consists of a stake. Metal location poster on spruce 4 from which corner bears South 30 lks., distinct cutting line running North from corner. 1997: Michigan DNR. Found wood post and two witnesses, not of record.

B. Description of corner evidence found and/or method applied in restoring or reestablishing corner:

(L9) No evidence of original survey or subsequent restoration found. Corner location falls in burned area now covered with scrubby second growth of spruce and cedar. Some old stumps found, but no marking found. Corner position re-established mid-point and on-line between the Northeast and Northwest corners of Section 25, and is accepted as a careful and faithful RE-ESTABLISHMENT of the position of the original corner.
(L11) No evidence of original survey or subsequent re-establishment found. No evidence of Forest Service location poster found. Conversation with local landowner revealed he set the wood post by compassing and taping from the Northwest corner of Section 36. Wood post is approximately 250 feet south of line between Section corners and was rejected. Corner position re-established mid-point and on-line between the Northeast and Northwest corners of Section 36, and is accepted as a careful and faithful RE-ESTABLISHMENT of the position of the original corner.

C. Description of monument for corner and accessories established to perpetuate locating the position of the corner:

(L9) DNR monument
8" Spruce S87E 15.35' (1/4S,NBT)
6" Spruce S13E 26.95' (1/4S,NBT)
7" Cedar N85W 21.35' (1/4S,NBT)
4" Spruce N06W 10.35' (1/4S,NBT)
All trees are blazed, scribed and painted. Measurements are to nail in side of tree, bearings are magnetic.
(L11) DNR monument
9" W. Birch N33E 12.5' (1/4S,NBT)
7" Cedar S78E 16.7' (1/4S,NBT)
8" Cedar S74W 20.25' (1/4S,NBT)
9" Cedar N03W 28.45' (1/4S,NBT)
All trees are blazed, scribed and painted. Measurements are to nail in side of tree, bearings are magnetic.

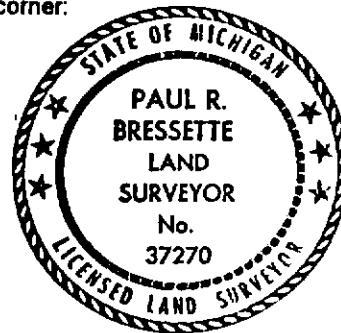

Signed by Paul R. Bressette
Surveyor's Michigan License No. 37270

Date

For the Michigan Department of Natural Resources - Forest Management Division