

37

LAND CORNER RECORDATION CERTIFICATE  
Filing Requirement of Act 74, Mich. P.A. 1970

For corners in

Delta  
(County)

Located In:

Corner Code #

1. Public Land Survey

T 42 R 22W  
T \_\_\_ R \_\_\_  
T \_\_\_ R \_\_\_  
T \_\_\_ R \_\_\_

2. Property Controlling  
in Section

S 36 T 42E R 22W 5 5  
S 36 T 42E R 22W 17 12

3. Miscellaneous  
Property in Sec.

S \_\_\_ T \_\_\_ R \_\_\_  
S \_\_\_ T \_\_\_ R \_\_\_

Register of Deeds Stamp & File Number

4. Lot No. \_\_\_\_\_, Recorded Plat \_\_\_\_\_  
5. Private Claims \_\_\_\_\_

12 Jul 23 1997  
5 Jul 26 1997

I, Paul R. Bressette, in a field survey on \_\_\_\_\_, 19\_\_\_\_ do hereby state that under requirements of P.A. 74, Michigan P.A. of 1970, the corner points mentioned in lines 1 and 2 above were in conformance with regulations and rules therefore as required in the current manual of survey instructions of the United States Department of the Interior, Bureau of Land Management or by a decree of a Court of Law and for that the corner points mentioned in lines 3, 4 and 5 above were in conformance with the rules of the Michigan Board of Land Surveyors or by a Decree of a Court of Law; established, re-established, monumented, recovered, found as expressed below:

NOTE: Not more than 2 corners, all in the same town and range, may be recorded on this certificate.

	A	B	C	D	E	F	G	H	I	J	K	L	M
1													
2	6		5		4		3		2		1		
3													
4	7		8		9		10		11		12		
5													
6	18		17		16		15		14		13		
7													
8	19		20		21		22		23		24		
9													
10	30		29		28		27		26		25		
11													
12	31		32		33		34		35		36		
13													

A. Description of original monument and accessories and/or subsequent restoration:

- (5) North One-sixteenth corner of Section 36. Not set in original survey, no evidence of subsequent establishment.
- (12) South One-sixteenth corner of Section 36. Not set in original survey, no evidence of subsequent establishment.

B. Description of corner evidence found and/or method applied in restoring or reestablishing corner:

- (5) Corner position established mid-point and on-line between the North and Center Quarter corners of Section 36.
- (12) Corner position established mid-point and on-line between the South and Center Quarter corners of Section 36.

C. Description of monument for corner and accessories established to perpetuate locating the position of the corner:

- |                                   |                                  |
|-----------------------------------|----------------------------------|
| (5) DNR monument                  | (12) DNR monument                |
| 7" B.Ash N19E 22.8' (1/16S,BT)    | 09" Cedar N47E 24.9' (1/16S,BT)  |
| 6" R.Maple N87E 14.55' (1/16S,BT) | 11" Cedar S20E 27.8' (1/16S,BT)  |
| 4" B.Ash S32W 24.2' (1/16S,BT)    | 07" Cedar S86W 11.65' (1/16S,BT) |
| 7" B.Ash N66W 35.7' (1/16S,BT)    | 06" Cedar N34W 5.55' (1/16S,BT)  |
- All trees are blazed, scribed and painted. Measurements are to nail in side of tree, bearings are magnetic.

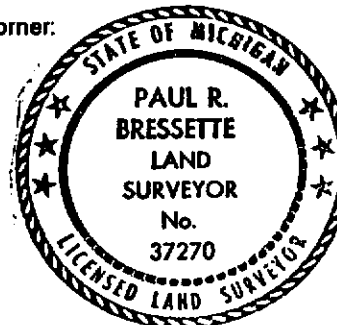

Signed by Paul R. Bressette  
Surveyor's Michigan License No. 37270

Date \_\_\_\_\_

For the Michigan Department of Natural Resources Forest Management Division