

MICHIGAN
DEPARTMENT OF CONSERVATION
FORESTRY DIVISION

LAND CORNER RECORD

T. 43 & 44 N.R. 23 W

Delta & Marquette COUNTY

DESCRIPTION OF CORNER Section Corner for Sections 32 | 33 T 44 N R 23 W

5 | 4 T 43 N R 23 W

CORNER MONUMENT 1" Iron Pipe with 4" Brass Cap

DATE MONUMENT PLACED AND WITNESSED 9-6-61

WITNESSES TO CORNER..... 12" Yellow Birch (S. 33) (NBT) N 14° E 24½ links

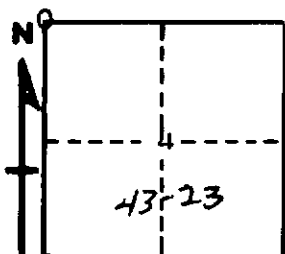

7" Soft Maple (S.32) (NBT) N 50° W 11½ links

AND

CIRCLE CORNER REGISTERED

DESCRIPTION IN DETAIL AS TO HOW CORNER WAS LOCATED AND IDENTIFIED OR RESTORED.

This corner was replaced from down post which fits with Y. Birch to SW, which has frame of curled growth and Hemlock badly decayed to NE. Both possible B.T.'s and in the proper distance and bearing from old post.

SURVEYOR'S SEAL

SIGNED Billy D. Buckler DATE April 27, 1964
REGISTERED LAND SURVEYOR
Billy D. Buckler