

SURVEY & REMONUMENTATION

APR 07 1995

COMMISSION

LAND CORNER RECORDATION CERTIFICATE
Filing Requirement of Act 74, Mich. P.A. 1970

For corners in Dickinson
 (County)

Located In: _____ Corner Code E-7

- 1. Public Land Survey Section 20 T 39N R 28W _____ E-7
- _____ T _____ R _____
- _____ T _____ R _____
- _____ T _____ R _____
- 2. Property Controlling S _____ T _____ R _____
- in Section S _____ T _____ R _____
- 3. Miscellaneous S _____ T _____ R _____
- Property in Sec. S _____ T _____ R _____

REGISTER OF DEEDS
 DICKINSON COUNTY
 1994 DEC -9 PM 3:44
 RECORDED

Register of Deeds Stamp & File Number

- 4. Lot No. _____, Recorded Plat _____
 - 5. Private Claims _____
- Sections 16, 17, 20 and 21

	A	B	C	D	E	F	G	H	I	J	K	L	M
2	6	5	4	3	2	1							
3													
4	7	8	9	10	11	12							
5													
6	18	17	16	15	14	13							
7													
8	19	20	21	22	23	24							
9													
10	30	29	28	27	26	25							
11													
12	31	32	33	34	35	36							
13													

I, John R. Garske, in a field survey on October 24 and 26, 19 94, do hereby certify that under requirements of P.A. 74, Michigan P.A. of 1970, the corner points mentioned in lines 1 and 2 above were in conformance with regulations and rules therefore as required in the current manual of survey instructions of the United States Department of the Interior, Bureau of Land Management or by a decree of a Court of Law and/or that the corner points mentioned in lines 3, 4 and 5 above were in conformance with the rules of the Michigan Board of Land Surveyors or by a Decree of a Court of Law; established, re-established, monumented, re-monumented, recovered, found as expressed below:

NOTE: Not more than 4 corners, all in the same town and range, may be recorded on this certificate.

A. Description of original monument and accessories and/or subsequent restoration:

1849 - Township subdivision by James H. Mullett, D.S. Original bearing trees: Y. pine 16" - N55°W, 39 links; W. pine 45" - S57°E, 19 links.

1910 & 1934 - Dickinson Co. Rd. Commission survey notes both indicate a 1" iron pin protruding 20" above ground at corner position. No original B.T.s found in 1910 but found roots of a stump N55°W, 23 feet. New B.T.s were set: pine stung 34" - S45°E, 13.2 feet; pine 7" - S77°W, 94.4 feet. In 1934 H.L. Wagner found the 1" iron pin and a 12" Norway pine at S81°W, 94.2 feet with centerline of road 89 feet north.

B. Description of corner evidence found and/or method applied in restoring or reestablishing corner:

Found a 1" iron pin protruding 20" above ground at ancient fence intersection. Fence runs south and east. A painted line runs west. I also found two existing bearing trees facing the corner. I am accepting this iron pin as being the same noted above and the best location for the true corner.

ACCEPTED BY THE DICKINSON COUNTY SURVEY PEER GROUP AS THE OFFICIAL CORNER UNDER MICHIGAN PUBLIC ACT 345 OF 1990 AT A MEETING HELD ON

1-23-95
ROIP

COUNTY REPRESENTATIVE

C. Description of monument for corner and accessories established to perpetuate locating the position of the corner:

Set aluminum Dickinson County monument at position of pin and established the following references: existing 5" maple B.T. - N44°E, 58.55 feet; 9" oak - S58°E, 27.32 feet; 8" oak - S41°W, 9.44 feet; existing 7" oak B.T. - N25°W, 14.28 feet; set carsonite witness post - West, 1.4 feet.

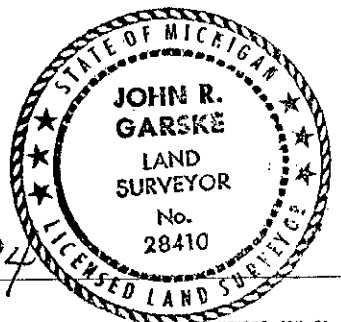

Signed by John R. Garske
 Surveyor's Michigan License No. 28410

Date 12/8/94

Sheet 2 E-7 Page 121