

SURVEY & REMONUMENTATION

APR 07 1995

LAND CORNER RECORDATION CERTIFICATE
Filing Requirement of Act 74, Mich. P.A. 1970

REGISTER OF DEEDS
 DICKINSON COUNTY
 100 N. MAIN ST. ANN ARBOR, MI 48106

1994 DEC -9 PM 3:45

RECORDED

For corners in Dickinson
 (County)

Located In:

Corner Code #

- 1. Public Land Survey Section 25 T 39N R 28W M-11
 T _____ R _____
 T _____ R _____
 T _____ R _____
- 2. Property Controlling S _____ T _____ R _____
 in Section S _____ T _____ R _____
- 3. Miscellaneous S _____ T _____ R _____
 Property in Sec. S _____ T _____ R _____

Register of Deeds Stamp & File Number

- 4. Lot No. _____, Recorded Plat _____
- 5. Private Claims _____
 Section corner 25, 36, T39N, R28W and 30, 31, T39N, R27W.

	A	B	C	D	E	F	G	H	I	J	K	L	M
2	6		5		4		3		2		1		
3													
4	7		8		9		10		11		12		
5													
6	18		17		16		15		14		13		
7													
8	19		20		21		22		23		24		
9													
10	30		29		28		27		26		25		
11													
12	31		32		33		34		35		36		
13													

I, John R. Garske, in a field survey on October 10, 1994, do hereby certify that under requirements of P.A. 74, Michigan P.A. of 1970, the corner points mentioned in lines 1 and 2 above were in conformance with regulations and rules therefore as required in the current manual of survey instructions of the United States Department of the Interior, Bureau of Land Management or by a decree of a Court of Law and/or that the corner points mentioned in lines 3, 4 and 5 above were in conformance with the rules of the Michigan Board of Land Surveyors or by a Decree of a Court of Law; established, re-established, monumented, re-monumented, recovered, found as expressed below:

NOTE: Not more than 4 corners, all in the same town and range, may be recorded on this certificate.

A. Description of original monument and accessories and/or subsequent restoration:

1847 - Original survey by A. Brevoort. Set post. Original bearing trees: birch 16" - S65°W, 11 links; sugar 10" - N35°W, 32 links.

1941 - Dickinson Co. Rd. Commission survey shows corner to be existing.

B. Description of corner evidence found and/or method applied in restoring or reestablishing corner:

I found a 1" O.D. iron pipe pointed out to us by a local resident who stated pipe has been there since 1951. It checks good with the GLO call of 1.8 chs. west to foot of hill. Accepted this pipe as the corner since it is in harmonious position and is generally accepted as the corner.

ACCEPTED BY THE DICKINSON COUNTY SURVEY PEER GROUP AS THE OFFICIAL CORNER UNDER MICHIGAN PUBLIC ACT 345 OF 1990 AT A MEETING HELD ON 1-23-95
ROP
 COUNTY REPRESENTATIVE

C. Description of monument for corner and accessories established to perpetuate locating the position of the corner:

Replaced 1" O.D. pipe with Dickinson County aluminum monument. Established following references: carsonite rail - North, 1.35 feet; 8" basswood - N41°E, 47.86 feet; 8" sugar maple - S17°E, 58.96 feet; 9" ash - S66°W, 3.39 feet; 6" basswood - N40°W, 21.59 feet.

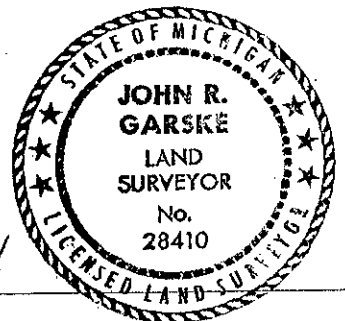

Signed by John R. Garske
 Surveyor's Michigan License No. 28410

Date 12/8/94