

LAND CORNER RECORDATION CERTIFICATE
Filing Requirement of Act 74, Mich. P.A. 1970

RECORDED

1999 NOV 30 PM 3:31

For corners in

DICKINSON
 (County)
NORWAY TOWNSHIP

Located In:

Corner Code #

- | | | |
|------------------------------------|-----------------------------|------------------------------------|
| 1. Public Land Survey | T <u>41</u> N R <u>29</u> W | <u>G-8</u> |
| | T <u>41</u> N R <u>29</u> W | <u>I-8</u> |
| | T ___ R ___ | ___ |
| | T ___ R ___ | ___ |
| 2. Property Controlling in Section | S ___ T ___ R ___ | <u>SURVEY & RECONSTITUTION</u> |
| | S ___ T ___ R ___ | ___ |
| 3. Miscellaneous Property in Sec. | S ___ T ___ R ___ | ___ |
| | S ___ T ___ R ___ | <u>MAR 24 2000</u> |

REGISTER OF DEEDS
 DICKINSON COUNTY
 RON MOORE, CLERK

Register of Deeds Stamp & File Number

4. Lot No. _____, Recorded Plat _____ SECTION _____
5. Private Claims _____

I, JAMES H. MOORE, in a field survey on AUGUST 25, 19 99 do hereby state that under requirements of P.A. 74, Michigan P.A. of 1970, the corner points mentioned in lines 1 and 2 above were in conformance with regulations and rules therefore as required in the current manual of survey instructions of the United States Department of the Interior, Bureau of Land Management or by a decree of a Court of Law and /or that the corner points mentioned in lines 3, 4 and 5 above were in conformance with the rules of the Michigan Board of Land Surveyors or by a Decree of a Court of Law; established, reestablished, monumented, recovered, found as expressed below:

	A	B	C	D	E	F	G	H	I	J	K	L	M
1													
2	6		5		4		3		2		1		
3													
4	7		8		9		10		11		12		
5													
6	18		17		16		15		14		13		
7													
8	19		20		21		22		23		24		
9													
10	30		29		28		27		26		25		
11													
12	31		32		33		34		35		36		
13													

NOTE: Not more than 2 corners, all in the same town and range, may be recorded on this certificate.

A. Description of original monument and accessories and/or subsequent restoration:

- | | |
|---|--|
| G-8 ¼ CORNER COMMON TO SECTIONS 21-22
IRONWOOD POST BY JOHN BURT, D.S. 1849
YELLOW BIRCH 18" N 44° W 34 LINKS
HEMLOCK 20" S 24° E 46 LINKS | I-8 ¼ CORNER COMMON TO SECTIONS 22-23
SPRUCE POST BY JOHN BURT, D.S. 1849
YELLOW PINE 10" S 40° W 21 LINKS
YELLOW PINE 10" N 45° E 48 LINKS |
|---|--|

B. Description of corner evidence found and/or method applied in restoring or reestablishing corner:

- | | |
|--|--|
| G-8 FOUND 1" PIPE WITH CAP BROKEN OFF,
SET BY BILL BUCKLER R.L.S. #08887. | I-8 FOUND 1" PIPE WITH 4" MICHIGAN DEPARTMENT OF CONSERVATION
BRASS CAP, SET BY BILL BUCKLER R.L.S. #08887. |
| 1959 BEARING TREES
5" MAPLE S 46° W 53 ½ LINKS
10" YELLOW BIRCH N 32° W 49 ½ LINKS | 1963 BEARING TREES
6" SPRUCE N 10° W 29 ½ LINKS
8" CEDAR S 72° E 81 ½ LINKS |

C. Description of monument for corner and accessories established to perpetuate locating the position of the corner:

- | | |
|---|--|
| G-8 SET DICKINSON COUNTY MONUMENT WITH 4" ALUMINUM CAP. NEW WITNESSES | I-8 FOUND ABOVE DESCRIBED MONUMENT. NEW WITNESSES |
| FOUND 10" MAPLE S 52° E 35.43' NAIL/TAG
FOUND 12" MAPLE N 3° E 25.45' NAIL/TAG
11" MAPLE S 40° E 14.35' NAIL/TAG
10" MAPLE N 76° W 20.35' NAIL/TAG
CARSONITE MARKER SOUTH 0.85' | FOUND 7" BLACK SPRUCE N 25° W 18.18'
FOUND 11" CEDAR S 70° E 54.38'
8" BLACK SPRUCE N 37° E 24.57'
15" CEDAR S 05° W 43.28'
CARSONITE MARKER SOUTH 0.60' |

Signed by James H. Moore Date 11-8-99
 Surveyor's Michigan License No. 28423

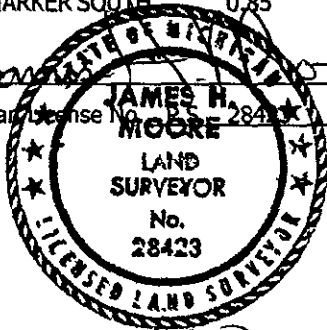

ACCEPTED BY THE DICKINSON COUNTY
 CLERK APPROVED BY MICHIGAN STATE BOARD OF PROFESSIONAL SURVEYORS, JAN. 28, 1971
 CORNER UNDER MICHIGAN PUBLIC ACT
 345 OF 1980 AT A MEETING HELD ON
11-23-99
Ron Moore
 COUNTY REPRESENTATIVE

REVISED MAY 14, 1975
 REVISED JAN., 1983
 REVISED OCT., 1995