

D-1/D-13 T42N-R30W **LAND CORNER RECORDATION CERTIFICATE**
Filing Requirement of Act 74, Mich. P.A. 1970

RECORDED

1999 NOV 30 PM 3:26

For corners in

DICKINSON Located In: Corner Code #
 (County)

SAGOLA TOWNSHIP

1. Public Land Survey T 41 N R 30 W D-1
 T R
 T R
 T R
 2. Property Controlling in Section S T R
 S T R
 3. Miscellaneous Property in Sec. S T R
 S T R

SURVEY & RE-MONUMENTATION

MAR 24 2000

REGISTERED PLATS
 DICKINSON COUNTY
 REALTY

Register of Deeds Stamp & File Number

4. Lot No. _____, Recorded Plat _____ SECTION _____

5. Private Claims _____

	A	B	C	D	E	F	G	H	I	J	K	L	M
1													
2	6			5		4		3		2		1	
3													
4	7		8		9		10		11		12		
5													
6	18		17		16		15		14		13		
7													
8	19		20		21		22		23		24		
9													
10	30		29		28		27		26		25		
11													
12	31		32		33		34		35		36		
13													

I, JAMES H. MOORE, in a field survey on NOVEMBER 4, 19 99 do hereby state that under requirements of P.A. 74, Michigan P.A. of 1970, the corner points mentioned in lines 1 and 2 above were in conformance with regulations and rules therefore as required in the current manual of survey instructions of the United States Department of the Interior, Bureau of Land Management or by a decree of a Court of Law and /or that the corner points mentioned in lines 3, 4 and 5 above were in conformance with the rules of the Michigan Board of Land Surveyors or by a Decree of a Court of Law; established, re-established, monumented, recovered, found as expressed below:

NOTE: Not more than 2 corners, all in the same town and range, may be recorded on this certificate.

A. Description of original monument and accessories and/or subsequent restoration:

D-1 ¼ CORNER COMMON TO SECTION 5, T41N-R30W & SECTION 32, T42N-R30W
 CEDAR POST BY WILLIAM A. BURT, D.S. 1846
 SPRUCE 14" N 16°E 26 LINKS
 CEDAR 8 " N 56°W 5 LINKS

ACCEPTED BY THE DICKINSON COUNTY SURVEY PEER GROUP AS THE OFFICIAL CORNER UNDER MICHIGAN PUBLIC ACT 345 OF 1990 AT A MEETING HELD ON 11-23-99

COUNTY REPRESENTATIVE

B. Description of corner evidence found and/or method applied in restoring or reestablishing corner:

D-1 FOUND FALLEN CEDAR POST 1 ½" BELOW GROUND AT SINGLE PROPORTIONATE LOCATION, ESTABLISHED CORNER POSITION AT SINGLE PROPORTIONATE LOCATION. THE FALLEN CEDAR POST MAY BE THE ORIGINAL POST SET IN 1846, AND FELL WITHIN ONE FOOT OF SINGLE PROPORTIONATE LOCATION.

C. Description of monument for corner and accessories established to perpetuate locating the position of the corner:

D-1 SET DICKINSON COUNTY MONUMENT
 6' LONG WITH 4" ALUMINUM CAP
 NEW WITNESSES

9" WHITE BIRCH N 59° E (M.B.) 31.44' NAIL/TAG
 4" BALSAM S 38° E (M.B.) 15.02' NAIL/TAG
 8" BLACK SPRUCE S 71°W (M.B.) 50.02' NAIL/TAG
 5" BLACK SPRUCE N 60°W (M.B.) 24.25' NAIL/TAG
 CARSONITE MARKER N 18°W (M.B.) 1.35'

Signed by _____ Date 11-8-99
 Surveyor's Michigan License No. 28423

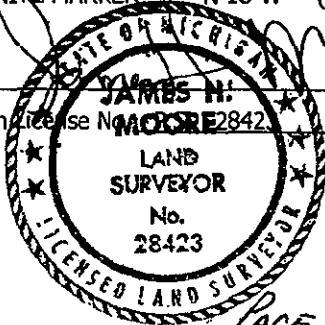

ACCEPTED BY THE DICKINSON COUNTY SURVEY PEER GROUP AS THE OFFICIAL CORNER UNDER MICHIGAN PUBLIC ACT 345 OF 1990 AT A MEETING HELD ON 11-23-99
 APPROVED BY THE BOARD OF PROFESSIONAL SURVEYORS, JAN. 28, 1971
 REVISED MAY 14, 1975
 REVISED JAN., 1983
 REVISED OCT., 1995

Liber 3

PAGE 18

RF R