

LAND CORNER RECORDATION CERTIFICATE  
Filing Requirement of Act 74, Mich. P.A. 1970

RECORDED

1998 DEC 14 PM 12:25

For corners in

Dickinson  
(County)

Located In:

Corner Code #

1. Public Land Survey

T 41NR 30W

G-2 Sagola Twp.

G-11 Breitung Twp.

T R

T R

T R

T R

T R

T R

T R

T R

T R

T R

T R

T R

T R

T R

T R

T R

T R

T R

T R

T R

T R

T R

T R

T R

T R

T R

T R

T R

T R

T R

T R

T R

T R

T R

T R

T R

T R

T R

T R

T R

T R

T R

T R

T R

T R

T R

T R

T R

T R

T R

T R

T R

T R

T R

T R

T R

T R

T R

T R

T R

T R

T R

T R

T R

T R

T R

T R

T R

T R

2. Property Controlling  
in Section

S

T R

S

T R

S

T R

S

T R

S

T R

S

T R

S

T R

S

T R

S

T R

S

T R

S

T R

S

T R

S

T R

S

T R

S

T R

S

T R

S

T R

S

T R

S

T R

S

T R

S

T R

S

T R

S

T R

S

T R

S

T R

S

T R

S

T R

S

T R

S

T R

S

T R

S

T R

S

T R

S

T R

S

T R

S

T R

S

T R

S

T R

S

T R

S

T R

S

T R

S

T R

S

T R

S

T R

S

T R

S

T R

S

T R

S

T R

S

T R

S

T R

S

T R

S

T R

S

T R

S

T R

S

T R

S

T R

S

T R

S

T R

S

T R

S

T R

S

T R

S

T R

S

T R

S

T R

S

T R

S

T R

S

T R

4. Lot No. \_\_\_\_\_, Recorded Plat \_\_\_\_\_  
5. Private Claims \_\_\_\_\_

REGISTER OF DEEDS  
DICKINSON COUNTY  
RON MOORE, CLERK

QUANTITY &  
REASON FOR RESTORATION

MARK SET 1999

Register of Deeds Stamp & File Number

SECTION

|    | A  | B  | C  | D  | E  | F  | G | H | I | J | K | L | M |
|----|----|----|----|----|----|----|---|---|---|---|---|---|---|
| 1  |    |    |    |    |    |    |   |   |   |   |   |   |   |
| 2  | 6  | 5  | 4  | ●  | 3  | 2  | 1 |   |   |   |   |   |   |
| 3  |    |    |    |    |    |    |   |   |   |   |   |   |   |
| 4  | 7  | 8  | 9  | 10 | 11 | 12 |   |   |   |   |   |   |   |
| 5  |    |    |    |    |    |    |   |   |   |   |   |   |   |
| 6  | 18 | 17 | 16 | 15 | 14 | 13 |   |   |   |   |   |   |   |
| 7  |    |    |    |    |    |    |   |   |   |   |   |   |   |
| 8  | 19 | 20 | 21 | 22 | 23 | 24 |   |   |   |   |   |   |   |
| 9  |    |    |    |    |    |    |   |   |   |   |   |   |   |
| 10 | 30 | 29 | 28 | 27 | 26 | 25 |   |   |   |   |   |   |   |
| 11 |    |    |    |    |    |    | ● |   |   |   |   |   |   |
| 12 | 31 | 32 | 33 | 34 | 35 | 36 |   |   |   |   |   |   |   |
| 13 |    |    |    |    |    |    |   |   |   |   |   |   |   |

I, Robert F. Perkins, in a field survey on Oct. 8, 1998 do hereby state that under requirements of P.A. 74, Michigan P.A. of 1970, the corner points mentioned in lines 1 and 2 above were in conformance with regulations and rules therefore as required in the current manual of survey instructions of the United States Department of the Interior, Bureau of Land Management or by a decree of a Court of Law and/or that the corner points mentioned in lines 3, 4 and 5 above were in conformance with the rules of the Michigan Board of Land Surveyors or by a Decree of a Court of Law; established, re-established, monumented, recovered, found as expressed below:

NOTE: Not more than 2 corners, all in the same town and range, may be recorded on this certificate.

A. Description of original monument and accessories and/or subsequent restoration:

G-2 1/2 Corner Common to Sections 4/3  
Post by John Burt, D.S. 1849  
Original Bearing Trees  
Hemlock 6" N34°E 24 Lk.  
Cedar 6" S14°W 20 Lk.

G-11 Section Corner Common to Sections 27-28-33-34  
Post by John Burt, D.S. 1849  
Original Bearing Trees  
W.Pine 36" N21°W 46 Lk.  
W.Pine 30" S35°E 34 Lk.

B. Description of corner evidence found and/or method applied in restoring or reestablishing corner:

G-2 No Evidence of Original Corner  
or its Accessories Found.  
Found 1" K.C. Corp. Pipe Monument  
set by N. Spherhake, RLS in 1965.  
Corner Report #1085  
1965 Bearing Trees:  
B.Ash 6" S57°E 139 Lk.  
Balm 17" N03°W 46 1/2 Lk.

G-11 No Evidence of Original Corner  
or its Accessories Found.  
Found 3/4" Iron referred to in Old Corner  
Report #818 by C.C. Lundgren, M.D.O.T. 1964  
M.D.O.T. Witnesses:  
T.Pole S35°W 84.48'  
F.Post N85°W 61.75'  
Aspen 8" N15°W 55.62'

C. Description of monument for corner and accessories established to perpetuate locating the position of the corner:

G-2 Accepted Pipe Monument described  
in "B" above.  
New Witnesses:  
Balm 10" N41°E(M.B.) 10.48' Nail/Tag  
Balm 12" S73°E(M.B.) 14.75' Nail/Tag  
W.Birch 8" N25°W(M.B.) 8.80' Nail/Tag  
Cherry 3" West 10.40' Nail/Tag  
Placed Carsonite Marker 1.0' South.

G-11 Accepted Iron Pin described in "B" above  
as Best Available Evidence of Corner Location.  
Placed 3/4" Stamped D.C. Remon. Cap on  
Existing Pin.  
New Witnesses:  
Cherry 5" N29°W(M.B.) 16.28' Nail/Tag  
Cherry 4" N67°W(M.B.) 13.10' Nail/Tag  
Aspen 8" N62°E(M.B.) 13.90' Nail/Tag  
8" Sq. Fence Post S10°E(M.B.) 28.45' Nail/Tag  
Placed Carsonite Marker 1.0' East.

Signed by Robert F. Perkins Date Oct. 28, 1998

Surveyor's Michigan License No. 2007 DICKINSON COUNTY PERKINS

SURVEY PEER GROUP AS THE OFFICIAL  
CORNER UNDER MICHIGAN PUBLIC ACT  
345 OF 1990 AT A MEETING HELD

12-7-98

ROBERT PERKINS  
COUNTY REPRESENTATIVE

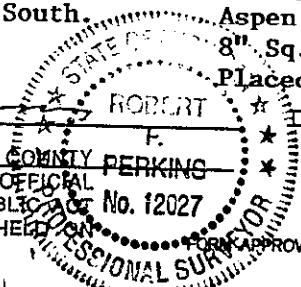

FORM APPROVED BY MICHIGAN STATE BOARD OF PROFESSIONAL SURVEYORS, JAN. 28, 1971

REVISED MAY 14, 1975  
REVISED JAN., 1983  
REVISED OCT., 1985

Liton? Page 411