

MICHIGAN
DEPARTMENT OF CONSERVATION
FORESTRY DIVISION

LAND CORNER RECORD

T. 42N N.R. 28W

Dickinson COUNTY

DESCRIPTION OF CORNER 1/2 cor. for secs. 23-24

CORNER MONUMENT 1" iron pipe with 4" aluminum cap.

DATE MONUMENT PLACED AND WITNESSED 10/6/66

WITNESSES TO CORNER..... 8" Aspen (1/2S)(NBT) N33°E, 06 1/2 lks.

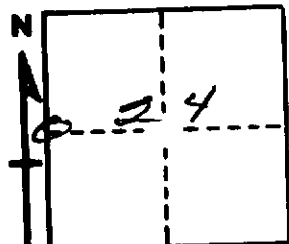

7" Aspen (1/2S)(NBT) S15°W, 15 1/2 lks.

AND

CIRCLE CORNER REGISTERED

DESCRIPTION IN DETAIL AS TO HOW CORNER WAS LOCATED AND IDENTIFIED OR RESTORED.

This corner was placed midway and on line bet. sec. cors. 1/2 mile to north and to south.

No original evidence found.

SURVEYOR'S SEAL

SIGNED F. J. Bray DATE 1/13/67
F. J. Bray
REGISTERED LAND SURVEYOR