

MICHIGAN
DEPARTMENT OF CONSERVATION
FORESTRY DIVISION

LAND CORNER RECORD

T. 43, 44 N. R. 27W

Dickinson COUNTY

DESCRIPTION OF CORNER $\frac{1}{4}$ Corner for sections $\frac{31}{6}$ T44N, R27W
T43N, R27W

CORNER MONUMENT 1" Iron Pipe with 4" Aluminum Cap.

DATE MONUMENT PLACED AND WITNESSED 5-5-61

WITNESSES TO CORNER..... Small dead aspen in vicinity.

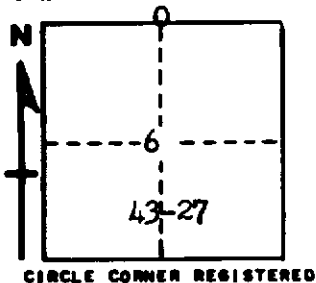

2' Rock S 41°W 16 links

2' Rock N 53°E 45 links

AND 3' Rock S 22°E 40 links

DESCRIPTION IN DETAIL AS TO HOW CORNER WAS LOCATED AND IDENTIFIED OR RESTORED.

This corner was single proportioned measurement and on line between Section Corners.
No original evidence.

SURVEYOR'S SEAL

SIGNED Billy D. Buckler DATE January 31, 1962
REGISTERED LAND SURVEYOR
Billy D. Buckler