

**LAND CORNER RECORDATION CERTIFICATE**  
**Filing Requirement of Act 74, Mich. P.A. 1970**

For corners in

Dickinson  
 (County)

Located in:

Corner Code #

1. Public Land Survey

T 43N R 28W H9  
 T \_\_\_\_\_ R \_\_\_\_\_  
 T \_\_\_\_\_ R \_\_\_\_\_  
 T \_\_\_\_\_ R \_\_\_\_\_

2. Property Controlling in Section

S 27 T 43N R 28W 9  
 S \_\_\_\_\_ T \_\_\_\_\_ R \_\_\_\_\_

3. Miscellaneous Property in Sec.

S \_\_\_\_\_ T \_\_\_\_\_ R \_\_\_\_\_  
 S \_\_\_\_\_ T \_\_\_\_\_ R \_\_\_\_\_

Register of Deeds Stamp & File Number

4. Lot No. \_\_\_\_\_, Recorded Plat \_\_\_\_\_  
 5. Private Claims \_\_\_\_\_

9 Jun 13 2001  
 H9 May 17 2001

I, Stephan J. Szyszkoski, in a field survey on \_\_\_\_\_, 19\_\_\_\_ do hereby state that under requirements of P.A. 74, Michigan P.A. of 1970, the corner points mentioned in lines 1 and 2 above were in conformance with regulations and rules therefore as required in the current manual of survey instructions of the United States Department of the Interior, Bureau of Land Management or by a decree of a Court of Law and/or that the corner points mentioned in lines 3, 4 and 5 above were in conformance with the rules of the Michigan Board of Land Surveyors or by a Decree of a Court of Law; established, re-established, monumented, recovered, found as expressed below:

**NOTE: Not more than 2 corners, all in the same town and range, may be recorded on this certificate.**

|    |    |    |    |    |    |    |   |   |   |   |   |   |
|----|----|----|----|----|----|----|---|---|---|---|---|---|
| A  | B  | C  | D  | E  | F  | G  | H | I | J | K | L | M |
| 1  |    |    |    |    |    |    |   |   |   |   |   |   |
| 2  | 6  | 5  | 4  | 3  | 2  | 1  |   |   |   |   |   |   |
| 3  |    |    |    |    |    |    |   |   |   |   |   |   |
| 4  | 7  | 8  | 9  | 10 | 11 | 12 |   |   |   |   |   |   |
| 5  |    |    |    |    |    |    |   |   |   |   |   |   |
| 6  | 18 | 17 | 16 | 15 | 14 | 13 |   |   |   |   |   |   |
| 7  |    |    |    |    |    |    |   |   |   |   |   |   |
| 8  | 19 | 20 | 21 | 22 | 23 | 24 |   |   |   |   |   |   |
| 9  |    |    |    |    |    |    |   |   |   |   |   |   |
| 10 | 30 | 29 | 28 | 27 | 26 | 25 |   |   |   |   |   |   |
| 11 |    |    |    |    |    |    |   |   |   |   |   |   |
| 12 | 31 | 32 | 33 | 34 | 35 | 36 |   |   |   |   |   |   |
| 13 |    |    |    |    |    |    |   |   |   |   |   |   |

**A. Description of original monument and accessories and/or subsequent restoration:**

(H9) Quarter corner common to Sections 22-27. Established in 1850 by John Burt: "...40.18 Set Cedar quarter Sec. post. Cedar 14 N75E 7, do 12 S30W 18".  
 (9-Sec. 27) East 1/16 corner, Section 27. Corner not established in the original survey. MDNR cruiser notes from 1949 show "IP" on sketch of Section 27.

**B. Description of corner evidence found and/or method applied in restoring or reestablishing corner:**

(H9) The original post and accessories were not recovered. Found no acceptable evidence of the position of the original corner on the ground. Reestablished the corner midway and on a line of mean true bearing between section corners 2652.90' east and west.  
 (9-Sec. 27) Established and monumented the corner midway and on a straight line between center of section 1331.79' west and quarter corner 1331.79' east. From the position established, I found a 3/4" iron pin with mushroomed top, not of record, S38W 7.83' distant which I did not accept for the corner.

**C. Description of monument for corner and accessories established to perpetuate locating the position of the corner:**

|                                                                                                                                                                                                                                                                                                   |                                                                                                                                                                                                                                                                                                   |
|---------------------------------------------------------------------------------------------------------------------------------------------------------------------------------------------------------------------------------------------------------------------------------------------------|---------------------------------------------------------------------------------------------------------------------------------------------------------------------------------------------------------------------------------------------------------------------------------------------------|
| (H9) Set 1" IDx32" iron pipe with 4" alum. MDNR cap. Blazed and scribed:<br>15" W.Pine N40E 60.5' "1/4S NBT"<br>4" Spruce S83E 4.8' do<br>5" Spruce N88W 12.1' do<br>6" Spruce N62W 23.5' do<br>Placed sq'd cedar post adjacent.<br>Bearings are magnetic. Distances are to notch in lower blaze. | (9) Set 1" IDx32" iron pipe with 4" alum. MDNR cap. Blazed and scribed:<br>5" Spruce N26E 24.3' "1/16S BT"<br>11" R.Pine S75E 48.4' do<br>9" Spruce S06E 45.7' do<br>4" Spruce N74W 19.8' do<br>Set squared cedar post adjacent.<br>Bearings are magnetic. Distances are to notch in lower blaze. |
|---------------------------------------------------------------------------------------------------------------------------------------------------------------------------------------------------------------------------------------------------------------------------------------------------|---------------------------------------------------------------------------------------------------------------------------------------------------------------------------------------------------------------------------------------------------------------------------------------------------|

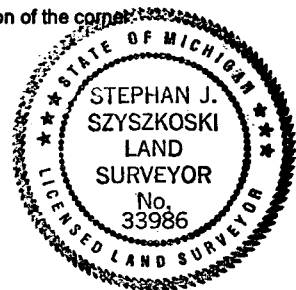

Signed by Stephan J. Szyszkoski Date 7/18/01  
 Surveyor's Michigan License No. 33986

For the Michigan Department of Natural Resources - Forest Management Division