

LAND CORNER RECORDATION CERTIFICATE
Filing Requirement of Act 74, Mich. P.A. 1970

For corners in

<u>Dickinson</u> (County)	Located In:	Corner Code #
1. Public Land Survey	T 44H R 28W	I12
	T 44H R 28W	I11
	T _____ R _____	_____
	T _____ R _____	_____
2. Property Controlling in Section	S _____ T _____ R _____	_____
	S _____ T _____ R _____	_____
3. Miscellaneous Property in Sec.	S _____ T _____ R _____	_____
	S _____ T _____ R _____	_____

Register of Deeds Stamp & File Number

4. Lot No. _____, Recorded Plat _____
 5. Private Claims _____

Nov 01 1999

I, Stephan J. Szyszkoski, in a field survey on _____, 19____ do hereby state that under requirements of P.A. 74, Michigan P.A. of 1970, the corner points mentioned in lines 1 and 2 above were in conformance with regulations and rules therefore as required in the current manual of survey instructions of the United States Department of the Interior, Bureau of Land Management or by a decree of a Court of Law and /or that the corner points mentioned in lines 3, 4 and 5 above were in conformance with the rules of the Michigan Board of Land Surveyors or by a Decree of a Court of Law, established, re-established, monumented, recovered, found as expressed below:

NOTE: Not more than 2 corners, all in the same town and range, may be recorded on this certificate.

A	B	C	D	E	F	G	H	I	J	K	L	M
1												
2	6	5	4	3	2	1						
3												
4	7	8	9	10	11	12						
5												
6	18	17	16	15	14	13						
7												
8	19	20	21	22	23	24						
9												
10	30	29	28	27	26	25						
11								●				
12	31	32	33	34	35	36		●				
13												

A. Description of original monument and accessories and/or subsequent restoration:

- (I12) Quarter corner common to Sections 34-35. Established in 1850 by John Burt: "39.98 Set cedar Quarter Section Post. Sugar 10 S38W 13, Y.Birch 14 N28E 16."
- (I11) Corner common to Sections 26-27-34-35. Established in 1850 by John Burt: "79.96 Section Corner 26,27,34 & 35. Sugar 26 N30E 40, Y.Birch 16 S67W 35."

B. Description of corner evidence found and/or method applied in restoring or reestablishing corner:

- (I12) The original post and accessories were not recovered. Found no acceptable evidence of the position of the original corner on the ground. Reestablished the corner midway and on a line of mean true bearing between Section corners 2631.26' north and south. At the position for the corner I placed a 1"I.D.x32" iron pipe capped with a 4" dia. cast aluminum MDNR tablet, appropriately stamped.
- (I11) The original post and accessories were not recovered. Found no acceptable evidence of the position of the original corner on the ground. Reestablished the corner by double proportionate measurement to the original record between section corners 1 mile to north, south, east, and west. At the position for the corner I placed a 1"I.D.x32" iron pipe capped with a 4" dia. cast aluminum MDNR tablet, appropriately stamped.

C. Description of monument for corner and accessories established to perpetuate locating the position of the corner:

- | | |
|---|--|
| (I12) Set 1" pipe with 4" MDNR cap. Blazed and scribed the following:
12" Sugar S29E 47.9' "1/4S NBT"
11" Sugar S35W 20.4' do
6" Sugar(SE'ly of 4) N67W 18.6' do
11" double Sugar N05W 24.3' do
Squared cedar post adjacent. Bearings are magnetic. Distances to notch in lower blaze. | (I11) Set 1" pipe with 4" MDNR cap. Blazed and scribed the following:
6" Aspen N15E 64.7' "S26 NBT"
10" Maple S11W 22.4' "S34 NBT"
10" Sugar N77W 32.4' "S27 NBT"
5" Sugar in clump N24W 13.8' "S27 NBT"
Squared cedar post adjacent. Bearings are magnetic. Distances to notch in lower blaze. |
|---|--|

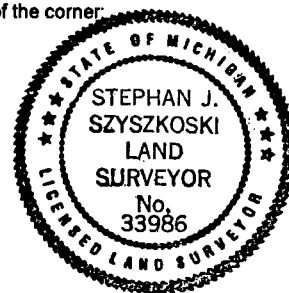

Signed by Stephan J. Szyszkoski Date 3/7/00
 Surveyor's Michigan License No. 33986

For the Michigan Department of Natural Resources - Forest Management Division