

MICHIGAN
DEPARTMENT OF CONSERVATION
FORESTRY DIVISION

LAND CORNER RECORD

T 44 N N.R. 28 & 29 W

Dickinson COUNTY

DESCRIPTION OF CORNER Section Corner for Sections T 44 N 1 / 6 T 44 N
R 29 W 12 / 7 R 28 W

CORNER MONUMENT Wood Post

DATE MONUMENT PLACED AND WITNESSED 11-6-63

WITNESSES TO CORNER..... 15" Y. Pine (S.1)(NBT) N 25° W 129 links

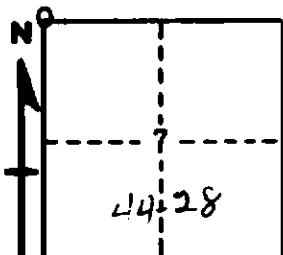

10" Y. Pine (S.6)(NBT) N 18° E 74 links

12" Y. Pine (S.7)(NBT) S 53° E 70 links

AND

CIRCLE CORNER REGISTERED

DESCRIPTION IN DETAIL AS TO HOW CORNER WAS LOCATED AND IDENTIFIED OR RESTORED.

This corner was placed on line and the single proportioned distance between Section Corners 1 mile to North and to South.

No original evidence.

SURVEYOR'S SEAL

SIGNED Billy D. Buckler DATE April 13, 1964
REGISTERED LAND SURVEYOR
Billy D. Buckler