

**LAND CORNER RECORDATION CERTIFICATE**  
 Filing Requirement of Act 74, Mich. P.A. 1970

For corners in  
Dickinson  
 (County)

Located In: Corner Code =#

1. Public Land Survey T 44N R 29W 11  
 T \_\_\_\_\_ R \_\_\_\_\_  
 T \_\_\_\_\_ R \_\_\_\_\_  
 T \_\_\_\_\_ R \_\_\_\_\_

2. Property Controlling S 2 T 44N R 29W 3  
 in Section S \_\_\_\_\_ T \_\_\_\_\_ R \_\_\_\_\_  
 3. Miscellaneous S \_\_\_\_\_ T \_\_\_\_\_ R \_\_\_\_\_  
 Property in Sec. S \_\_\_\_\_ T \_\_\_\_\_ R \_\_\_\_\_

4. Lot No. \_\_\_\_\_, Recorded Plat \_\_\_\_\_

5. Private Claims \_\_\_\_\_

Register of Deeds Stamp & File Number

I, Stephan J. Szyszkoski, in a field survey on August 02, 1994, 19\_\_\_\_, do hereby certify that under requirements of P.A. 74, Michigan P.A. of 1970, the corner points mentioned in lines 1 and 2 above were in conformance with regulations and rules therefore as required in the current manual of survey instructions of the United States Department of the Interior, Bureau of Land Management or by a decree of a Court of Law and/or that the corner points mentioned in lines 3, 4 and 5 above were in conformance with the rules of the Michigan Board of Land Surveyors or by a Decree of a Court of Law, established, re-established, monumented, re-monumented, recovered, found as expressed below:

NOTE: Not more than 4 corners, all in the same town and range, may be recorded on this certificate.

|    |   |   |   |   |   |   |   |   |   |   |   |   |   |
|----|---|---|---|---|---|---|---|---|---|---|---|---|---|
|    | A | B | C | D | E | F | G | H | I | J | K | L | M |
| 2  |   |   |   |   |   |   |   |   |   |   |   |   |   |
| 3  |   |   |   |   |   |   |   |   |   |   |   |   |   |
| 4  |   |   |   |   |   |   |   |   |   |   |   |   |   |
| 5  |   |   |   |   |   |   |   |   |   |   |   |   |   |
| 6  |   |   |   |   |   |   |   |   |   |   |   |   |   |
| 7  |   |   |   |   |   |   |   |   |   |   |   |   |   |
| 8  |   |   |   |   |   |   |   |   |   |   |   |   |   |
| 9  |   |   |   |   |   |   |   |   |   |   |   |   |   |
| 10 |   |   |   |   |   |   |   |   |   |   |   |   |   |
| 11 |   |   |   |   |   |   |   |   |   |   |   |   |   |
| 12 |   |   |   |   |   |   |   |   |   |   |   |   |   |
| 13 |   |   |   |   |   |   |   |   |   |   |   |   |   |

A. Description of original monument and accessories and/or subsequent restoration:

(1) Corner common to Sections 2-3 T44N-R29W and 34-35 T45N-R29W. Corner monumented by single proportionate measurement in 1961 by Billy D. Buckler. 1" Pipe with 4" brass cap. 1961 NBTs were 9" J. Pine N70E 14 links, 10" J. Pine S10E 62 links, 9" J. Pine S45W 103 links. Found no subsequent record.

(3-Sec. 2) North 1/16 corner between Sections 2-3. Corner monumented in 1965 by Billy D. Buckler, RLS. 1" pipe with 4" aluminum cap. 9" Jack Pine N65W 37 links, 8" Jack Pine S71E 19 links. Found no subsequent record.

B. Description of corner evidence found and/or method applied in restoring or reestablishing corner:

(1) Found the 1961 monument, in good condition, at record bearing and distance from the 1961 NBTs: J. Pine NE is dead, J. Pine SE is now a stump, J. Pine SW in good condition (1994 mag. bearing is S40N). Left the monument as found and marked two additional witnesses as described below.

(3-Sec. 2) Found the 1965 monument, as described, in good condition, at record bearing and distance from the 1965 BTs: the Jack Pine NW in good condition, the Jack Pine SE now a stump. Left the monument as found and marked three new witnesses as described below.

C. Description of monument for corner and accessories established to perpetuate locating the position of the corner:

(1) Found 1" pipe with 4" brass cap. Blazed and scribed the following new bearing trees:  
 0" J. Pine N53E 35.1' "S35 NBT"  
 10" Aspen N30W 44.0' "S34 NBT"  
 Bearings are magnetic.

(3) Found 1" pipe with 4" alum. cap. Blazed and scribed the following bearing trees:  
 4" Balsam N63E 26.3' "1/16S NBT"  
 5" J. Pine S49E 45.0' "1/16S NBT"  
 6" J. Pine S34W 45.0' "1/16S NBT"  
 Bearings are magnetic.

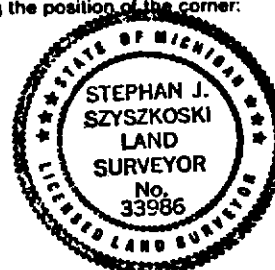

Signed by Stephan J. Szyszkoski Date 9-21-94  
 Surveyor's Michigan License No. 33986