

DEC 01 1993

COMMISSION

FILED

copy

93 NOV 10 PM 12: 23

LAND CORNER RECORDATION CERTIFICATE
Filing Requirement of Act 74, Mich. P.A. 1970

For corners in
EATON

Located In:

Corner Code ##

LINDA M. TWITCHELL
REGISTER OF DEEDS
EATON COUNTY, MICH.

HAMLIN TOWNSHIP

1. Public Land Survey	T	1N	R	3W	A-5
	T		R		
	T		R		
	T		R		
2. Property Controlling in Section	S		T	R	
	S		T	R	
3. Miscellaneous Property in Sec.	S		T	R	
	S		T	R	

LIBER 3 PAGE 327

Register of Deeds Stamp & File Number

4. Lot No. _____, Recorded Plat _____
5. Private Claims _____

A	B	C	D	E	F	G	H	I	J	K	L	M
2	6	5	4	3	2	1						
3												
4	7	8	9	10	11	12						
5												
6	18	17	16	15	14	13						
7												
8	19	20	21	22	23	24						
9												
10	30	29	28	27	26	25						
11												
12	31	32	33	34	35	36						
13												

RONALD L. ENGER in a field survey on AUGUST 31, 1993

do hereby certify that under requirements of P.A. 74, Michigan P.A. of 1970, the corner points mentioned in lines 1 and 2 above were in conformance with regulations and rules therefore as required in the current manual of survey instructions of the United States Department of the Interior, Bureau of Land Management or by a decree of a Court of Law and/or that the corner points mentioned in lines 3, 4 and 5 above were in conformance with the rules of the Michigan Board of Land Surveyors or by a Decree of a Court of Law; established, re-established, monumented, re-monumented, recovered, found as expressed below:

NOTE: Not more than 4 corners, all in the same town and range, may be recorded on this certificate.

A. Description of original monument and accessories and/or subsequent restoration:

1. POST SET IN ORIGINAL GOVERNMENT SURVEY BY HERVEY PARKE, DEPUTY SURVEYOR ON JANUARY 17, 1826 WITH THE FOLLOWING STATEMENT: INTERSECTED RANGE LINE 1.65 (108.9') N. AND THE FOLLOWING WITNESSES:
HICKORY 24 S74E .53 (35.0')
W OAK 40 N6 1/2°E .72-1/2 (47.8')

CONTINUED ON BACK

B. Description of corner evidence found and/or method applied in restoring or reestablishing corner:

SEARCHED AT APPARENT LOCATION OF CORNER AND FOUND 3/4" PIPE WITH CAP #11370 IN MONUMENT BOX. IT IS IN CLOSE ACCORD WITH POSITION RECORDED BY STEADMAN (ITEM 4) AS PROVED BY HIS POWER POLE IN SE QUAD WITNESS AND HIS CALL TO MARKER FOR M-5 T1N R4W. ALSO FOUND 1/2 INCH BAR ABOUT 1 FOOT NORTH AND 2 FOOT EAST OF THE PIPE, WHICH IS MARKER SET BY LESTER, PROVED BY HIS POWER POLE WITNESS IN SW QUAD (NOW A POST HOLE) (ITEM 3). I THINK THAT STEADMAN FOUND THE CORNER POINT MONUMENTATION DESCRIBED BY BAILEY (ITEM 2) AND HAVE FAITH THAT HE PROPERLY REMONUMENTED THE CORNER POINT WITH HIS PIPE. I AGREE WITH STEADMAN THAT THE STONE IS BETTER EVIDENCE OF THE ORIGINAL CORNER POSITION THAN THE EVIDENCE PROVIDED BY THE PHYSICAL CENTERLINE OF THE ROADS, AND THEREFORE ACCEPT STEADMAN'S PIPE AS A MARKER AT THE CORNER POSITION.

C. Description of monument for corner and accessories established to perpetuate locating the position of the corner:

A-5 T1N R3W
3/4" PIPE WITH CAP #11370 IN MONUMENT BOX
N.W. CORNER HOUSE FOUNDATION, 121° AZ., 196.00'
FOUND NAIL & TAG #13039 (ARDEN PIERSON) IN POWER POLE, 107° AZ., 137.07'
CAPPED IRON, 135° AZ., 47.43'
3/4" CAPPED PIPE AT SE CORNER SECTION 12, T1N, R4W, 180° AZ., 109.10'
CENTERLINE GAS VENT PIPE, 327° AZ., 51.26'
1/2" BAR, 57° AZ., 2.15'
CORNER IS 3' WEST OF CENTERLINE ~~PIPERMENT FOR~~ ROYSTON ROAD

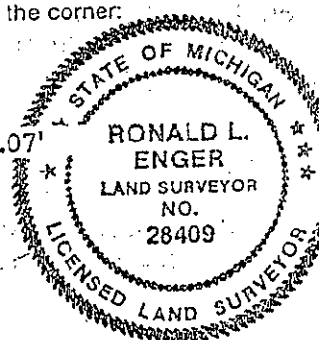

Signed by R. Enger Date OCTOBER 26, 1993
Surveyor's Michigan License No. 28409

A-5 T1N R3W PART A CONTINUED

2. M. H. BAILEY, COUNTY SURVEYOR, REPORTED USING CORNER IN A SURVEY IN SECTION 18, DATED FEB. 1880 AND RECORDED IN VOLUME 2, PAGE 110 & 111, RECORD OF SURVEYS, AS "STAKE, BRICK, STONES". NO WITNESSES ARE GIVEN.

3. RONNIE LESTER LS #18998 RECORDED CORNER IN LIBER 1 OF CORNERS, PAGE 197 ON JANUARY 4, 1973, IN FIELD SURVEY ON NOVEMBER 13, 1972 RE-ESTABLISHED CORNER THUS: "SET 1/2" BAR IN CENTERLINE OF ROYSTON AND NYE ROADS", WITH THE FOLLOWING WITNESSES:

SET NAIL & TAG W. SIDE POWER POLE, SW, 112.56'
SET NAIL & TAG NW SIDE POWER POLE, NE, 130.83'

4. RICHARD STEADMAN LS #11370 RECORDED CORNER IN LIBER 2 OF CORNERS, PAGE 878 ON MARCH 29, 1983. IN FIELD SURVEY ON OCTOBER 2, 1973: "DUG HOLE IN THE INTERSECTION OF ROYSTON RD. AND NYE HWY., AND FOUND A STONE WITH BROKEN BRICK AND CROCKERY AROUND IT. THE 1/2" IRON ROD RECORDED IN LIBER 1, PAGE 197 OF LAND CORNER RECORDATION CERTIFICATES IN 2 FT. EAST AND 1 FT. NORTH." RAISED LOCATION OF STONE TO SURFACE WITH A 3/4" IRON PIPE AND CAP, WITH THE FOLLOWING WITNESSES:

POWER POLE S72°E 137.15'

ROAD SIGN POST S55°W 44.09'

TELEPHONE POLE S17°W 111.09'

THE CORNER FOR T1N,R4W, (SET 3/4" IRON PIPE AT 165 LK. = 108.9' JOG SOUTH) PER U.S. PUBLIC LAND SURVEY FIELD NOTES.