

SURVEY &  
REMONUMENTATION

APR 27 1995

COMMISSION

LAND CORNER RECORDATION CERTIFICATE  
Filing Requirement of Act 74, Mich. P.A. 1970

FILED  
Copy  
94 NOV -3 AM 11:22

For corners in

EATON COUNTY  
(County)

Located In:

Corner Code #

WALTON TOWNSHIP

1. Public Land Survey	T	<u>1N</u>	R	<u>5W</u>	<u>I-5</u>
	T		R		
	T		R		
	T		R		
2. Property Controlling in Section	S		T		R
	S		T		R
3. Miscellaneous Property in Sec.	S		T		R
	S		T		R

LINDA M. TWITCHELL  
REGISTER OF DEEDS  
EATON COUNTY, MICH.

LIBER 3 PG 482

Register of Deeds Stamp & File Number

4. Lot No. \_\_\_\_\_, Recorded Plat \_\_\_\_\_  
5. Private Claims \_\_\_\_\_

	A	B	C	D	E	F	G	H	I	J	K	L	M
2	6		5		4		3		2				
3													
4	7		8		9		10		11		12		
5									13				
6	18		17		16		15		14		13		
7													
8	19		20		21		22		23		24		
9													
10	30		29		28		27		26		25		
11													
12	31		32		33		34		35		36		
13													

DAVID R. LOHR, in a field survey on OCT. 15, 1994, do hereby certify that under requirements of P.A. 74, Michigan P.A. of 1970, the corner points mentioned in lines 1 and 2 above were in conformance with regulations and rules therefore as required in the current manual of survey instructions of the United States Department of the Interior, Bureau of Land Management or by a decree of a Court of Law and/or that the corner points mentioned in lines 3, 4 and 5 above were in conformance with the rules of the Michigan Board of Land Surveyors or by a Decree of a Court of Law; established, re-established, monumented, re-monumented, recovered, found as expressed below:

NOTE: Not more than 4 corners, all in the same town and range, may be recorded on this certificate.

A. Description of original monument and accessories and/or subsequent restoration:

- I-5: 1. POST SET BY SYLVESTER SIBLEY, U.S. DEP. SURVEYOR IN 1825.  
WITNESSED BY: BEECH 22" S 37 E 06 lks (3.96')  
BEECH 5" N 18 1/2 W 13 lks (8.58')
2. MARGINAL NOTE IN EATON CO. ROAD COMM. COPY OF GLO. NOTES SHOWS "SECTION COR., AXE. SHAFT. WITH BRICK AND CROCKERY, 5.63' NW OF STA. 153 + 36.50 ON TANGENT."

CONTINUED ON BACK

B. Description of corner evidence found and/or method applied in restoring or reestablishing corner:

- I-5: FOUND 1" BAR IN MON. BOX AS PER LIBER 1, PG. 389. FOUND 2 OF 4 WITNESSES OF ITEMS 4, 5, 6, AND 7 AND ACCEPTED 1" IRON AS PERPETUATION OF 1936 CORNER. IRON IS 14" DEEP IN MON. BOX AND LIES 7.2' +/- NW'LY OF C/L OF OLD 27. LEFT 1" BAR IN MON. BOX.

C. Description of monument for corner and accessories established to perpetuate locating the position of the corner:

- I-5: 1" IRON BAR IN MON. BOX 7.2' NW'LY OF C/L OF OLD 27.  
SET N&T 30090 IN E/S 36" MAPLE AZ. 29° 117.50'  
SET N&T 30090 IN SE/S P. POLE AZ. 78° 106.60'  
SET N&T 30090 IN SW/S P. POLE AZ. 137° 59.70'  
SET N&T 30090 IN SW/S 24' OAK AZ. 255° 62.40'  
SET N&T 30090 IN NE/S 15" ELM AZ. 351° 49.00'

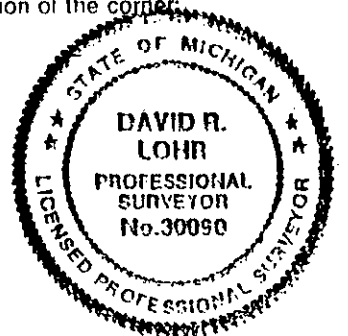

Signed by David R. Lohr

Date OCTOBER 25, 1994

Surveyor's Michigan License No. 30090

P.A. 345 EATON COUNTY  
PEER APPROVED 10/26/94 ML

Page 2

## 1.5 PART A - CONTINUED

2. WITNESSED BY: 4" OAK S 77° 30' W 62.00'  
 24" MAPLE S 29° 00' E 79.13'  
 4" ELM N 75° 30' E 76.01'  
 20" ELM S 76° 00' E 96.88'

MARGINAL NOTE IS NOT DATED OR INITIALED, HOWEVER, IT CAN PROBABLY BE ATTRIBUTED TO HARVEY A. WILLIAMS, CO. SURVEYOR.

3. NO OTHER REFERENCES FOUND IN COUNTY SURVEYORS RECORDS.

4. CORNER WITNESSED BY F.K. HOLMES, RLS #14094 FOR MDOT, APRIL 1966. WITNESSES ON FILE AT EATON CO. RD COMMISSION. CORNER SHOWN AS "P.K. IN MAC. OVER MONUMENT BAR IN CONC.

WITNESSED BY: S 85° W 61.40' 16" OAK  
 N 20° W 55.13' T.P.  
 N 20° E 84.13' 36" MAPLE  
 S 40° E 56.35' P. POLE

5. CORNER WITNESSED BY ARDEN S. PIERSON, P.S. #13039 FOR MDOT, JUNE 1966. WITNESSES ON FILE AT EATON COUNTY ROAD COMMISSION. CORNER SHOWN AS "1" IRON PIN IN MON. BOX, 7.3' N.W. OF C/L US 27 PAVT."

NOTE ON CARD STATES "1936 CORNER". 1" PIN WITNESSED BY:

N 30° E 80.19' 36" MAPLE  
 N 10° W 50.87' TEL. POLE  
 S 35° E 59.41' P. POLE  
 S 75° W 61.50' 16" OAK

6. CORNER REFERENCED ON OCT. 15, 1973, BY FRED N. WHITE, PS #12034. SURVEY #73-2446 AND RECORDED IN LIBER PG. 549 (SURVEYS).

WITNESSES TO SW CORNER (SECTION 11) 1" IRON IN MON. BOX.

36" MAPLE N 30° E 80.19'  
 POWER POL S 35° E 59.41'  
 16" OAK S 75° W 61.50'

7. CORNER REFERENCED ON OCT. 30, 1973, ON A LCRC BY RON HELSEL, PS #18994 RECORDED IN LIBER 1, PG. 389. (IN CONJUNCTION WITH SURVEY OF ITEM 6 ABOVE) 1" PIN IN MON. BOX - WITNESSES ACQUIRED FROM THE EATON COUNTY ROAD COMMISSION. WITNESSED BY:

36" MAPLE N 30° E 80.19'  
 TEL POLE N 10° W 50.87'  
 POWER POLE S 35° E 59.41'  
 16 " OAK S 75° W 61.50'

6/10/1973

1/10/1973

1/10/1973

1/10/1973

1/10/1973

