

**SURVEY &
REMONUMENTATION**

APR 27 1995

FILED

copy

LAND CORNER RECORDATION CERTIFICATE

Filing Requirement of Act 74, Mich. P.A. 1970

94 NOV -3 AM 11:23

For corners in **COMMISSION**

<u>EATON COUNTY</u> (County)	Located In:	Corner Code #
<u>WALTON TOWNSHIP</u>	T <u>1N</u> R <u>5W</u>	<u>L-5</u>
1. Public Land Survey	T _____ R _____	_____
	T _____ R _____	_____
	T _____ R _____	_____
	T _____ R _____	_____
2. Property Controlling In Section	S _____ T _____ R _____	_____
	S _____ T _____ R _____	_____
3. Miscellaneous Property In Sec.	S _____ T _____ R _____	_____
	S _____ T _____ R _____	_____

LINDA M. TWITCHELL
REGISTER OF DEEDS
EATON COUNTY, MICH.

LIBER 3 PG 486

Register of Deeds Stamp & File Number

4. Lot No. _____, Recorded Plat _____
5. Private Claims _____

I, DAVID R. LOHR, in a field survey on OCT. 15, 1994, do hereby certify that under requirements of P.A. 74, Michigan P.A. of 1970, the corner points mentioned in lines 1 and 2 above were in conformance with regulations and rules therefore as required in the current manual of survey instructions of the United States Department of the Interior, Bureau of Land Management or by a decree of a Court of Law and/or that the corner points mentioned in lines 3, 4 and 5 above were in conformance with the rules of the Michigan Board of Land Surveyors or by a Decree of a Court of Law; established, re-established, monumented, re-monumented, recovered, found as expressed below:

A	B	C	D	E	F	G	H	I	J	K	L
2	6	5	4	3	2						
3											
4	7	8	9	10	11	12					
5											
6	18	17	16	15	14	13					
7											
8	19	20	21	22	23	24					
9											
10	30	29	28	27	26	25					
11											
12	31	32	33	34	35	36					
13											

NOTE: Not more than 4 corners, all in the same town and range, may be recorded on this certificate.

A. Description of original monument and accessories and/or subsequent restoration:

- L-5: 1. POST SET BY SYLVESTER SIBLEY, U.S. DEP. SURVEYOR IN 1825.
WITNESSED BY: BEECH 7" S 34 E 14 1 (9.24')
BEECH 9" N 21 W 13 1 (8.58')
2. CORNER REFERENCED IN SURVEY BY WM. SIMPSON, COUNTY SURVEYOR, DATED NOV. 1871 AND RECORDED IN VOL. 1 PG. 150-151. AS "STONE AND CROCKERY, ESTABLISHED" NO WITNESSES GIVEN.
CONTINUED ON BACK

B. Description of corner evidence found and/or method applied in restoring or reestablishing corner:

- L-5: FOUND 1/2" IRON WITH CAP #11370 IN CENTERLINE NYE HIGHWAY AND ON BRUSH AND TREE LINE TO NORTH AS PER LIBER 2, PG. 571. ALL THREE WITNESS TREES GONE. ACCEPTED IRON AS CORNER BASED ON TESTIMONY OF SURVEYOR STEADMAN AS IN ITEM A-3 ABOVE. LEFT 1/2" IRON IN PLACE.

C. Description of monument for corner and accessories established to perpetuate locating the position of the corner:

- L-5: 1/2" IRON WITH CAP #11370 ON CENTERLINE NYE HIGHWAY AND TREE LINE NORTH.
WITNESSED BY:
SET NAIL/TAG #30090 E/S 8" BL WALNUT AZ. 04° 64.41'
SET NAIL/TAG #30090 W/S P. POLE AZ. 61° 188.00'
SOUTHWEST CORNER HOUSE #460 NYE AZ. 75° 222.40'
SET NAIL/TAG #30090 W/S P. POLE AZ. 175° 153.85'
SET NAIL/TAG #30090 S/S 10" TW. ELM AZ. 283° 68.24'

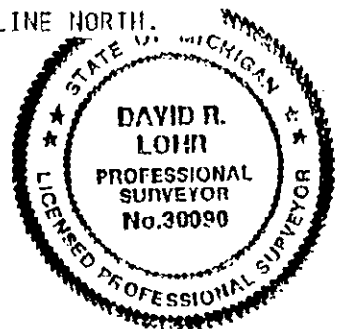

Signed by David R. Lohr Date OCTOBER 25, 1994

Surveyor's Michigan License No. 30090
P.A. 345 EATON COUNTY
PEER APPROVED 10/26/94 DL

Page 2

L-5 PART A - CONTINUED

3. CORNER REFERENCED ON LCRC BY RICHARD STEADMAN PS #11370, DATED 8/27/78 RECORDED IN LIBER 2 PG. 571. HE RESTATES FACTS IN ITEM #2 AND STATES "DUG HOLE IN NYE HIGHWAY OPPOSITE FENCE NORTH AND ABOUT 12" DEEP, FOUND A 4" DIAMETER CLAY PIPE WITH STONES AND CROCKERY AROUND IT." "DEPOSITED RAILROAD SPIKES AROUND CLAY PIPE AND RAISED ITS LOCATION TO SURFACE WITH 1/2" IRON PIPE." WITNESSES:

4" POPLAR	N 17° W	19.69 FT.
10" BOX ELDER	N 40° W	27.23 FT.
3" HICKORY	N 71° W	63.27 FT.

- 4) CORNER REFERENCED IN SURVEY BY ROBERT REED PS #19004 DATED 10/27/83 AND RECORDED IN LIBER 3 PG. 597. "1/2" IRON PIPE" SAME WITNESSES AS ITEM #3 ABOVE.

5. NO OTHER REFERENCES FOUND.