

EATON COUNTY REMONUMENTATION

DEC 1 8 1996

96 OCT -9 PM 12:19

COMMISSION

LAND CORNER RECORDATION CERTIFICATE

Filing Requirement of Act 74, Mich. P.A. 1970

For corners in

EATON

(County)

Located In:

Corner Code =#

LINDA M. TWITCHELL
REGISTER OF DEEDS
EATON COUNTY, MICH.

- 1. Public Land Survey
- CENTER SECTION 7
- BELLEVUE TOWNSHIP

T 1 N R 6 W B-4

- 2. Property Controlling in Section S T R
- 3. Miscellaneous Property in Sec. S T R

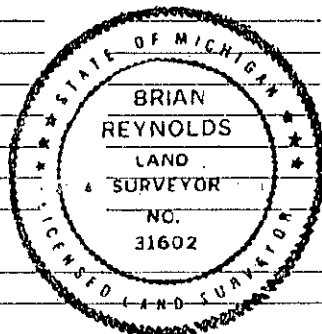

k.3 pg 706

Register of Deeds Stamp & File Number

- 4. Lot No. _____, Recorded Plat _____
- 5. Private Claims _____

	A	B	C	D	E	F	G	H	I	J	K	L	M
2	6	5	4	3	2	1							
3													
4		8	9	10	11	12							
5													
6	18	17	16	15	14	13							
7													
8	19	20	21	22	23	24							
9													
10	30	29	28	27	26	25							
11													
12	31	32	33	34	35	36							
13													

I, BRIAN REYNOLDS, in a field survey on APRIL 26, 1996

do hereby certify that under requirements of P.A. 74, Michigan P.A. of 1970, the corner points mentioned in lines 1 and 2 above were in conformance with regulations and rules therefore as required in the current manual of survey instructions of the United States Department of the Interior, Bureau of Land Management or by a decree of a Court of Law and/or that the corner points mentioned in lines 3, 4 and 5 above were in conformance with the rules of the Michigan Board of Land Surveyors or by a Decree of a Court of Law; established, re-established, monumented, re-monumented, recovered, found as expressed below:

NOTE: Not more than 4 corners, all in the same town and range, may be recorded on this certificate.

A. Description of original monument and accessories and/or subsequent restoration:

- 1. CORNER NOT SET BY THE GENERAL LAND OFFICE.
- 2. SURVEY OF SECTION 7 BY COUNTY SURVEYOR FRANK DAVIS, MAY 1870, COUNTY SURVEYOR RECORDS VOLUME 1, PAGES 106-107, "STONE & C." DAVIS DOES NOT EXPLICITLY NOTE THAT HE INTERSECTED THE 1/4 LINES, BUT THE NOTES IMPLY THAT HE DID.
- 3. PRIVATE NOTES OF KING & CARR, INC. c. 1983, "SET 1/2" IRON, NAIL IN E SIDE OF EAST TRUNK TWIN 12" ELM, S16W, 127.92; NAIL IN E SIDE OF 12" WALNUT, N24E, 41.97; NAIL IN S SIDE OF P.P., N64W, 164.96
- 4. UNRECORDED SURVEY BY ROBERT R. CARR, P.S. #20704, DATED AUGUST 4, 1983, KING & CARR, INC. JOB #83706, CALLS FOR 1/2" IRON AND WALNUT AND POWER POLE WITNESSES FROM ITEM #3 ABOVE.
- 5. AN UNRECORDED SURVEY BY DANIEL M. RYAN, P.S. #34975, KING, RYAN & ASSOCIATES JOB #9403086, DATED MAY 6, 1994, OF THREE PARCELS IN THE SOUTHEAST 1/4 OF SECTION 7, APPARENTLY BUT NOT EXPLICITLY IS TIED TO THE IRON REFERENCED IN ITEMS 3 AND 4 ABOVE.
- 6. TWO UNRECORDED SURVEYS BY WILLIAM K. CRANE, P.S. #29243, CRANE LAND SURVEYING JOB #23134, DATED 7/27/94, AND JOB #23861, DATED 1/8/96, OF PARCELS IN THE NORTHWEST 1/4 OF SECTION 7, APPARENTLY BUT NOT EXPLICITLY ARE TIED TO THE IRON REFERENCED IN ITEMS 3 AND 4 ABOVE.

B. Description of corner evidence found and/or method applied in restoring or reestablishing corner:

FOUND IRON AND WITNESSES BY CARR FROM ITEM #3 OF PART "A." TRAVERSED ENTIRE SECTION 7, TYING IN OCCUPATION LINES AS INDICATED BY DAVIS SURVEY (ITEM 2 ABOVE). OCCUPATION LINES LEAD TO A POSITION 30+/- NORTH AND 16+/- FEET EAST OF THE POSITION OCCUPIED BY THE FOUND IRON BY CARR. EXCAVATED AT POSITION INDICATED BY OCCUPATION, FOUND THREE STONES, STACKED ALMOST VERTICALLY. EXCAVATED FURTHER, FOUND NEARLY VERTICAL COLUMN OF CHARCOAL BELOW STACKED STONES. ACCEPTED STONES AND CHARCOAL AS POSITION MONUMENTED BY DAVIS. IT APPEARS THAT THE FOUND IRON WAS SET AT THE INTERSECTION OF LINES FROM FALSE 1/4 CORNERS. DISREGARDED FOUND IRON NOTED IN ITEMS 3 THROUGH 6 OF PART "A" ABOVE, SET REMON IRON IN CENTER OF COLUMN OF CHARCOAL.

C. Description of monument for corner and accessories established to perpetuate locating the position of the corner:

- SET EATON COUNTY REMONUMENTATION MONUMENT (3/4"x24" SOLID IRON WITH PLASTIC CAP STAMPED "ACT 345 31602)
- SET 20d NAIL W/ PLASTIC TAG IN THE NORTHWEST SIDE OF A 6" ELM S53°W 6.07'
- SET 20d NAIL W/ PLASTIC TAG IN THE SOUTHEAST SIDE OF A 6" CHERRY S76°W 9.92'
- SET 20d NAIL W/ PLASTIC TAG IN THE SOUTH SIDE OF A 14" BLACK WALNUT S89°E 1.75'
- SOUTHEAST CORNER OF THE FOUNDATION OF A FRAME RESIDENCE N32°W 107.58'
- NORTHEAST CORNER OF THE FOUNDATION OF A FRAME RESIDENCE N25°W 129.68'
- TOP CENTER OF AN ALUMINUM WELL CAP N17°W 108.75'
- IN LINE WITH THE WEST EDGE OF THE GRAVEL ROAD SOUTH, IN LINE WITH THE NORTH EDGE OF THE GRAVEL ROAD WEST

signed by [Signature]

Date JUNE 24, 1996

Surveyor's Michigan License No. 31602

P.A. 345 EATON COUNTY FORM APPROVED BY MICHIGAN STATE BOARD OF LAND SURVEYORS, JAN. 28, 1971

PEER APPROVED 6/27/96

REVISED MAY 14, 1975
REVISED JAN., 1983