

DEC 1 2 1997

COMMISSION

EATON COUNTY REMONUMENTATION

LAND CORNER RECORDATION CERTIFICATE
Filing Requirement of Act 74, Mich. P.A. 1970

FILED

Copy

97 DEC -2 AM 10:30

For Corners in EATON Located In: _____ Corner Code # _____
(county)

1. Public Land Survey T 1N R 6W C-2
1/4 CORNER COMMON TO T _____ R _____
SECTIONS 5 & 6 T _____ R _____
BELLEVUE TOWNSHIP T _____ R _____

2. Property Controlling S _____ T _____ R _____
in Section S _____ T _____ R _____

3. Miscellaneous S _____ T _____ R _____
Property in Sec. S _____ T _____ R _____

4. Lot No _____, Recorded Plat _____
5. Private Claims _____

LINDA M. TWITCHELL
REGISTER OF DEEDS
EATON COUNTY, MICH.

LIBER 3 PAGE 871

Register of Deeds Stamp & File Number

Brian Reynolds, in a field survey on 31 JULY, 1997 do hereby certify that under requirements of P.A. 74, Michigan P.A. of 1970, the corner points mentioned in lines 1 and 2 above were in conformance with regulations and rules therefore as required in the current manual of survey instructions of the United States Department of the Interior, Bureau of Land Management or by a decree of a Court of Law and/or that the corner points mentioned in lines 3, 4, and 5 above were in conformance with the rules of the Michigan Board of Land Surveyors or by a Decree of a Court of Law; established, re-established, monumented, re-monumented, recovered, found is expressed below.

| A | B | C | D | E | F | G | H | I | J | K | L | M |
|----|----|----|----|----|----|----|---|---|---|---|---|---|
| 2 | 6 | 5 | 4 | 3 | 2 | 1 | | | | | | |
| 3 | | | | | | | | | | | | |
| 4 | 7 | 8 | 9 | 10 | 11 | 12 | | | | | | |
| 5 | | | | | | | | | | | | |
| 6 | 18 | 17 | 16 | 15 | 14 | 13 | | | | | | |
| 7 | | | | | | | | | | | | |
| 8 | 19 | 20 | 21 | 22 | 23 | 24 | | | | | | |
| 9 | | | | | | | | | | | | |
| 10 | 30 | 29 | 28 | 27 | 26 | 25 | | | | | | |
| 11 | | | | | | | | | | | | |
| 12 | 31 | 32 | 33 | 34 | 35 | 36 | | | | | | |
| 13 | | | | | | | | | | | | |

NOTE: Not more than 2 corners, all in the same town and range, may be recorded on this certificate.

A. Description of original monument and accessories and/or subsequent restoration:

- GENERAL LAND OFFICE: MUSGROVE EVANS, D.S., APRIL, 1826 (T1N, R6W, P.517) "40.00 SET 1/4 SEC. POST" SUGAR 16 N25E 13 BEECH 14 S35E 35
- COUNTY SURVEYOR RECORDS: OSCAR CHURCH, JUNE 8, 1878 (V. 1, P.231) "STONE" NO WITNESSES GIVEN

*** NO OTHER HISTORICAL INFORMATION, PUBLIC OR PRIVATE, AVAILABLE FOR THIS CORNER ***

3. Description of corner evidence found and/or method applied in restoring or reestablishing corner:

FOUND NO MAGNETIC EVIDENCE OF CORNER MONUMENTATION. EXCAVATION WITH BACKHOE REVEALED NO EVIDENCE OF PREVIOUS MONUMENTATION. TRAVERSED ALL OF SECTION 6, TYING IN OCCUPATION THROUGHOUT. 1/4 LINE OCCUPATION (FIELD BREAK/INTERMITTENT TREE LINE NEAR ROAD AND DECAYING FENCE LINE FURTHER WEST) TO THE WEST FROM C-2 IS 12' NORTH OF OLD OCCUPATION FENCE LINE TO THE EAST. DISTANCE FROM 1/8 LINE OCCUPATION (SOUTH) TO FENCE LINE EAST AT C-2 IS 1320.73' AND DISTANCE FROM 1/8 LINE OCCUPATION TO C-6 IS 1320.72'.

SET STANDARD EATON COUNTY REMONUMENTATION MONUMENT (3/4" X 36" IRON W/PLASTIC CAP) ON CENTERLINE OF HILL ROAD AND IN LINE WITH OCCUPATION FENCE EAST.

C. Description of monument for corner and accessories established to perpetuate locating the position of the corner:

- SET STANDARD EATON COUNTY REMONUMENTATION MONUMENT (3/4" X 36" IRON) WITH PLASTIC CAP.
- SET 20d NAIL W/PLASTIC TAG IN THE NORTH SIDE OF A WOODEN FENCE CORNER POST S89°W 28.98
- SET 20d NAIL W/PLASTIC TAG IN THE SOUTHWEST SIDE OF A 12" BLACK WALNUT S54°W 31.29'
- SET 20d NAIL W/PLASTIC TAG IN THE NORTHWEST ROOT OF AN 8" MAPLE S38°W 52.60'
- SET 20d NAIL W/PLASTIC TAG IN THE NORTH SIDE OF AN 8" MAPLE S66°W 35.92'
- SET 20d NAIL W/PLASTIC TAG IN THE WEST SIDE OF A 13" ASH S27°W 43.64'
- ON CENTERLINE OF NORTH-SOUTH GRAVEL ROAD (HILL ROAD)
- IN LINE WITH FENCE LINE EAST
- C-1 LIES N00°28'42"E 2764.96'
- C-3 LIES S00°19'49"W, 2641.43'
- B-2 LIES N89°13'42"W 2654.04'

P.A. 345 EATON COUNTY
PEER APPROVED 9/18/97 *HL*

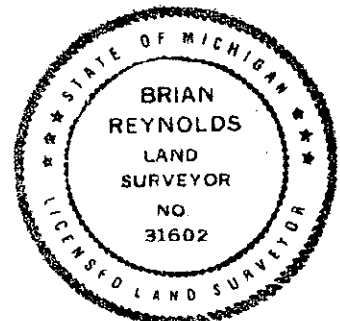

Signed by *[Signature]*
Surveyor's Michigan License No. 31602

Date DEC 15, 1997