

DEC 1 2 1997

COMMISSION

LAND CORNER RECORDATION CERTIFICATE  
Filing Requirement of Act 74, Mich. P.A. 1970

FILED

For corners in Eaton Rapids Township

EATON COUNTY	Located In:	Corner Code #
1. Public Land Survey	T <u>2N</u> R <u>3W</u>	<u>K-9</u>
	T _____ R _____	_____
	T _____ R _____	_____
	T _____ R _____	_____
2. Property Controlling in Section	S _____ T _____ R _____	_____
	S _____ T _____ R _____	_____
3. Miscellaneous Property in Sec.	S _____ T _____ R _____	_____
	S _____ T _____ R _____	_____

copy  
97 DEC -2 AM 10:04

LINDA M. TWITCHELL  
REGISTER OF DEEDS  
EATON COUNTY, MICH.

LIBER 3 PAGE 850  
Register of Deeds Stamp & File Number

4. Lot No. \_\_\_\_\_, Recorded Plat \_\_\_\_\_  
5. Private Claims \_\_\_\_\_

I, Maurice H. Mahieu, in a field survey on Oct. 9, 1997 do hereby state that under requirements of P.A. 74, Michigan P.A. of 1970, the corner points mentioned in lines 1 and 2 above were in conformance with regulations and rules therefore as required in the current manual of survey instructions of the United States Department of the Interior, Bureau of Land Management or by a decree of a Court of Law and /or that the corner points mentioned in lines 3, 4 and 5 above were in conformance with the rules of the Michigan Board of Land Surveyors or by a Decree of a Court of Law; established, re-established, monumented, recovered, found as expressed below:

1	A	B	C	D	E	F	G	H	I	J	K	L	M
2		6		5		4		3		2		1	
3													
4		7		8		9		10		11		12	
5													
6		18		17		16		15		14		13	
7													
8		19		20		21		22		23		24	
9													
10		30		29		28		27		26		25	
11													
12		31		32		33		34		35		36	
13													

NOTE: Not more than 2 corners, all in the same town and range, may be recorded on this certificate.

A. Description of original monument and accessories and/or subsequent restoration:

- Original corner was set by Hervey Parke D.S. in 1826; bearing tree 6" Beech N 33° E 17 1/2 lks and Beech S 41° W 13 lks.
- Marginal note in 1927 on Page 50 of the ECRC copy of GLO notes, Survey H. A. Williams calls for this corner to be marked by a stone with a gas pipe on top witnessed by an anchor post N 56° 10' E 29.3 ft. and an anchor post S 25° 40' W 72.75 feet.
- LCRC recorded in Liber 1, Page 391 on Feb. 7, 1974 by Fred N. White P.S. 12034 as "Set 1/2" iron rod in centerline of Arch and Toles Road by double proportionate measurement. Witnessed by: Power Pole N 41° 30' W 39.15 feet; Stop sign Pole N 85° E 47.00 feet; Power Pole S 35° 30' E 79.77 feet.
- LCRC by N. C. Jones P.S. 02934 recorded in Liber 1, Page 188 on May 23, 1974 calls for found 3/8" iron rod near centerline of gravel road at a "T" intersection of Arch and Toles Roads. Witnessed by S 30° E 79.79 feet Power Pole and Telephone Pole; S 40° W 39.15 feet Telephone Pole.
- An Act 132 survey recorded in Liber 1, Page 867 on June 5, 1975 by Edwin Swan, P.S. #2214 calls for corner to be Found 1/2" iron rod. No witnesses.
- LCRC recorded in Liber 2, Page 555 on Aug. 28, 1978 by Richard W. Steadman P.S. 11370 "Dug holes in the intersection of Arch Road and Toles Highway and found 3/4" iron pipe with stones around it. Raised location of 3/4" iron pipe to the surface with a 1/2" iron rod." Witnessed by Telephone pole S 39° W 35.69 feet; Electric Pole S 29° E 77.45 feet; 3" Elm N 23° E 120.16 feet; 1/2" iron rod (L1, P391 & L2 P188) in 4.1 ft. North and 0.5' East."

(Continued on Back

B. Description of corner evidence found and/or method applied in restoring or reestablishing corner:

Found 1/2" rebar at intersection of Toles Hwy. and Arch Road. 1/2" rebar is 0.75' below top of gravel surface. Excavated 12" diameter hole and found 1/2" iron rebar inside of 3/4" iron pipe, 3/4" iron pipe is 1.5' ± below surface. A of Steadman's witnesses are gone. Got magnetic pull at location of 1/2" rod, L1, Page 391. Placed cap stamped "PA 345 PS 28414" on found 1/2" rebar. The location of Steadman's 1/2" rebar appears to be the position of the 1927 Williams corner and appears to represent the historical and perpetuated location for this corner.

C. Description of monument for corner and accessories established to perpetuate locating the position of the corner:

Found 1/2" rebar and placed cap stamped "PA 345 PS 28414" witnessed by:  
Found Nail and Tag #12034 Northeast side Utility S 32° W 56.94 feet  
Found Nail and Tag #12034 East side Box Elder clump S 84° W 25.98 feet  
Found Nail and Tag #12034 Northwest side Utility Pole (New Pole) S 32° E 74.45 feet  
Set Nail and Tag #28414 North side 8" Maple S 40° E 98.27 feet

Signed by Maurice H. Mahieu  
Surveyor's Michigan License No. 28414

Date 11-25-97

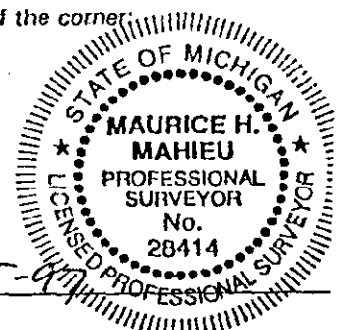

FORM APPROVED BY MICHIGAN STATE BOARD OF PROFESSIONAL SURVEY

K-9 Continued

7. An Act 132 survey recorded in Liber 3, Page 379 on Oct. 15, 1981 by Richard W. Steadman P.S. 11370. Monumentation and witnesses same as A-5.
8. An Act 132 survey recorded in Liber 2, Page 635 on Aug. 22, 1978 by Richard W. Steadman P.S. 11370. Monumentation and witnesses same as A-6.
9. An Act 132 survey recorded in Liber 2, Page 641 on Aug. 22, 1978 by Richard W. Steadman P.S. 11370. Monumentation and witnesses same as A-6. Measured 2612.06 to L-9, 2646.86 to K-10.
10. An Act 132 survey recorded in Liber 2, Page 69 on Aug. 24, 1978 by Richard W. Steadman P.S. 11370. Monumentation and witnesses same as A-6. Measured 2612.06 to L-9, 2642.67 to K8.
11. An Act 132 survey recorded in Liber 2, Page 783 on Nov. 14, 1978 by Harold Oliver P.S. #6354. Witnesses same as A-3. No monumentation.
12. An Act 132 survey recorded in Liber 2, Page 784 on Nov. 14, 1978 by Harold Oliver P.S. #6354. Witnesses same as A-3. No monumentation.
13. An Act 132 survey recorded in Liber 2, Page 932 on May 30, 1979 by Richard W. Steadman P.S. #11370. Monumentation and witnesses same as A-6. Measured 2642.68 to K-8.
14. An Act 132 survey recorded in Liber 3, Page 105 on Feb. 20, 1980 by Arden S. Pierson P.S. #13039. Monumentation and witnesses same as A-6.
15. An Act 132 survey recorded in Liber 3, Page 107 on Feb. 20, 1980 by Richard W. Steadman, P.S. #11370. Monumentation and witnesses same as A-6.
16. An Act 132 survey recorded in Liber 3, Page 201 on September 22, 1980 by Hathaway Hanes P.S. #5260. No monumentation or witnesses given.
17. An Act 132 survey recorded in Liber 3, Page 401 on Dec. 18, 1981 by Ronnie M. Lester P.S. #18998. No monumentation given. Witnesses same as A-6. Measured 2656.35 to L-9. (J-9) ? <sup>MM</sup>
18. An act 132 survey recorded in Liber 5, Page 286 on Dec. 27, 1990 by Richard W. Steadman, P.S. #11370. Monumentation and witnesses same as A-6.
19. An Act 132 survey recorded in Liber 4, Page 889 on March 25, 1990 by Peter Beaver P.S. #25828. Monumentation and witnesses same as A-6.
20. An Act 132 survey recorded in Liber 5, Page 627 on Aug. 3, 1993 by Peter Beaver #25828. No monumentation, witnesses same as A-6. Measured 2612.16 to L-9.
21. LCRC in Liber 3, Page 42 on June 14, 1994 by Peter Beaver P.S. #25828; "Found and verified 1/2" rod as noted in LCRC recorded in Liber 2, Page 555 and from adjacent surveys". Witnesses: Power Pole S 29° E 77.45 feet; Nail and Tag North and South 12" Elder West 32.32 feet; Nail and Tag Northwest Corner post N 35° E 54.74 feet; Nail and Tag South and South Corner post N 70° E 68.65 feet.
22. An Act 132 survey recorded in Liber 5, Page 836 on June 14, 1994 by Peter Beaver P.S. #25828. Monumentation and witnesses same as A-21. Measured 2611.96 to L-9.
23. An Act 132 survey recorded in Liber 6, Page 535 on Nov. 25, 1996 by Peter Beaver P.S. #25828. Monumentation and witnesses same as A-21. Measured 2642.55 to K-8, 2611.96 to L-9.