

DEC 17 1998

FILED

SECTION

LAND CORNER RECORDATION CERTIFICATE  
Filing Requirement of Act 74, Mich. P.A. 1970

98 NOV 30 PM 3: 19

For corners in Eaton Rapids Township

EATON COUNTY	Located In:	Corner Code #
1. Public Land Survey	T <u>2N</u> R <u>3W</u>	<u>M-7</u>
	T _____ R _____	_____
	T _____ R _____	_____
	T _____ R _____	_____
2. Property Controlling in Section	S _____ T _____ R _____	_____
	S _____ T _____ R _____	_____
3. Miscellaneous Property in Sec.	S _____ T _____ R _____	_____
	S _____ T _____ R _____	_____

LINDA M. TWITCHELL  
REGISTER OF DEEDS  
EATON COUNTY, MICH.

LIBER 3 PAGE 987  
Registrar of Deeds Stamp & File Number

4. Lot No. \_\_\_\_\_, Recorded Plat \_\_\_\_\_  
5. Private Claims \_\_\_\_\_

I, Maurice H. Mahieu, in a field survey on April 17, 1998 and do hereby state that under requirements of P.A. 74, Michigan P.A. of 1970, the corner points mentioned in lines 1 and 2 above were in conformance with regulations and rules therefore as required in the current manual of survey instructions of the United States Department of the Interior, Bureau of Land Management or by a decree of a Court of Law and /or that the corner points mentioned in lines 3, 4 and 5 above were in conformance with the rules of the Michigan Board of Land Surveyors or by a Decree of a Court of Law; established, re-established, monumented, recovered, found as expressed below:

NOTE: Not more than 2 corners, all in the same town and range, may be recorded on this certificate.

	A	B	C	D	E	F	G	H	I	J	K	L	M
1													
2		6		5		4		3		2		1	
3													
4		7		8		9		10		11		12	
5													
6		18		17		16		15		14		13	
7													
8		19		20		21		22		23		24	
9													
10		30		29		28		27		26		25	
11													
12		31		32		33		34		35		36	
13													

A. Description of original monument and accessories and/or subsequent restoration:

- Original Corner was set by Hervey Parke D.S. in 1826  
Set Post Corner Sect. 13 & 24; Beech 9 S 58° W 93 lks.; Beech 8 N 5° W 18 lks., V1, P44.
- Ingham County Surveyor R. J. Robb Vol. 5 Page 58 in a survey of Section 18, T2N, R2W. Witnesses Section 18, SW Corner to Wagon Skein Eaton Co. Cor. 1.40 chn (92.40 feet) North. Survey is undated.
- LCRC recorded in Liber 1, Page 380 by Richard Steadman PS #11370 in February 5, 1974 re-established corner using County Surveyor R. J. Robb's notes from Ingham County Record of Surveys, Vol. 5, Page 58. Steadman set 3/4" iron pipe and cap witnessed by Nail and Tag in Power Pole Southwest 68.48 feet; Nail and Tag in Telephone Pole West-North-West 78.62 feet; Nail and Tag in Telephone Pole East-South-East 33.23 feet; Corner common to Sections 18 & 19 T2N, R2W, (Set 3/4" iron pipe and cap) is 92.40 feet South.

(Continued On Back)

B. Description of corner evidence found and/or method applied in restoring or reestablishing corner:

Found 3/4" pipe with cap #11370 ±83' North of Centerline Bunker Hwy. And ±4' East of East edge of asphalt on Waverly Road. Top of pipe was 0.8' below surface and in good condition. Found Witnesses: Nail and Tag #30090 in Southeast side telephone pole S 71° W 87.47 feet; Nail and Tag #18998 in Southeast side telephone pole S 71° W 87.72 feet; Nail & Tag #30090 in North side Power Pole S 78° E 33.09 feet; 3/4" bar with cap #28414 in monument box at Northwest Corner, Sec. 19, Aurelius Township, T2N-R2W, S 02° W 82.49 feet. Found witnesses matched those previously recorded. Left pipe in place. Measured 2,654.82 to M-8. Accepted corner as perpetuated location from Steadman's work in 1974.

C. Description of monument for corner and accessories established to perpetuate locating the position of the corner:

- Found 3/4" pipe with cap #11370 and left in position, witnessed by:
- Nail and Tag #30090 in Southeast side Telephone Pole S 71° W 87.47 feet
- Nail and Tag #18998 in Southeast side Telephone Pole S 71° W 87.72 feet
- Northwest Corner old school house N 61° E 79.56 feet
- Nail and Tag #28414 in Northwest side 12" Pine N 44° E 55.59 feet
- Nail and Tag #30090 in North side Power Pole S 78° E 33.09 feet
- Found 3/4" bar & cap #28414 in Monument Box (A-7 Aurelius) South 82.49 feet (Recorded in Liber 9, Page 90)

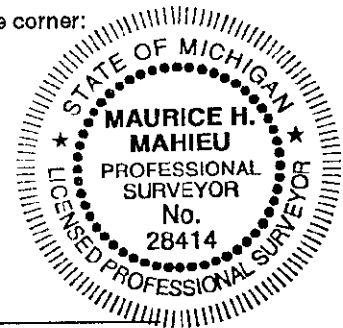

Signed by Maurice H. Mahieu  
Surveyor's Michigan License No. 28414

Date 11-3-98

P.A. 345 EATON COUNTY  
PEER APPROVED 6/23/98 M

## A. (CONTINUED)

4. LCRC recorded in Liber 2, Page 463 by Laverne Hendryx PS #3276 in September 21, 1977; #4 iron set from adjacent corners; Center of new pole East 30.25 feet; Southwest corner of House East-North-East 68.7 feet; Iron in Monument Box Southerly 79.88 feet; Center of Pole Southwest 88.81 feet.
5. An Act 132 survey recorded in Liber 2, Pages 431-432 on September 21, 1977 by Laverne Hendryx PS #3276. Measured 2,638.25 to L-7.
6. An Act 132 survey recorded in Liber 4, Page 588 on February 8, 1989 by Maurice Mahieu PS #28414. Found 3/4" iron pipe Telephone Pole S 71° W 87.63 feet; 4" Pine N 44° E 55.50 feet; Telephone Pole S 78° E 33.00 feet; Northwest Corner Old School House N 61° E 79.50 feet.
7. An Act 132 survey recorded in Liber 4, Pages 689-690 on September 11, 1989 by Maurice Mahieu PS #28414; Measured 2,653.10 to M-6; Monumentation and Witnesses same as A-6.
8. An Act 132 survey recorded in Liber 4, Pages 589-591 on February 8, 1989 by Maurice Mahieu PS #28414; Measured 2,653.10 to M-6; Monumentation and Witnesses same as A-6.
9. An Act 132 survey recorded in Liber 4, Pages 694-695 on September 11, 1989 by Maurice Mahieu PS #28414; Measured 2,653.10 to M-6; Monumentation and Witnesses same as A-6.
10. An Act 132 survey recorded in Liber 4, Pages 891-893 on March 27, 1990 by Larry Bryan PS #25832; Found 3/4" pipe and cap #11370 at 12 feet more or less East of centerline Waverly Road. Found Nail and Tag #18998 South side Utility Pole S 40° W 87.70 feet; Found Nail and Tag #11370 North side Telephone Pole, S 80° E 32.95 feet; Found 1/2" Bar in Monument Box, Northwest Corner Section 19, T2N, R2W, South 82.35 feet. Measured 2,635.47 to L-7.
11. An Act 132 survey recorded in Liber 5, Pages 248 on December 26, 1990 by Ron Helsel PSS #18994 notes: The section corner established in Liber 1, Page 380 was obliterated by telephone line construction. The subsequent corner established in Liber 2, Page 463 was found to be in closer accord with early county survey records.
12. An Act 132 survey recorded in Liber 6, Page 706 on January 31, 1997 by Marvin Fouty PS #18989. Measured 2,635.57 to L-7. No reference to Monumentation or Witnesses.