

DEC 12 1997

COMMISSION

97 NOV 24 AM 10:26

LAND CORNER RECORDATION CERTIFICATE  
Filing Requirement of Act 74, Mich. P.A. 1970

For corners in

EATON COUNTY  
(County)

Located In:

Corner Code #

CARMEL TOWNSHIP

1. Public Land Survey

T 2N R 5W L-12

T R

T R

T R

2. Property Controlling in Section

S T R

S T R

3. Miscellaneous

S T R

Property in Sec.

S T R

LINDA M. TWITCHELL  
REGISTER OF DEEDS  
EATON COUNTY, MICH.

copy

Liber 3 pg 835

Register of Deeds Stamp & File Number

4. Lot No. \_\_\_\_\_, Recorded Plat \_\_\_\_\_

5. Private Claims \_\_\_\_\_

I, DAVID L. CLIFFORD, in a field survey on SEPTEMBER 12, 1997 do hereby state that under requirements of P.A. 74, Michigan P.A. of 1970, the corner points mentioned in lines 1 and 2 above were in conformance with regulations and rules therefore as required in the current manual of survey instructions of the United States Department of the Interior, Bureau of Land Management or by a decree of a Court of Law and /or that the corner points mentioned in lines 3, 4 and 5 above were in conformance with the rules of the Michigan Board of Land Surveyors or by a Decree of a Court of Law; established, re-established, monumented, recovered, found as expressed below:

NOTE: Not more than 2 corners, all in the same town and range, may be recorded on this certificate.

1	A	B	C	D	E	F	G	H	I	J	K	L	M
2	6		5		4		3		2		1		
3													
4	7		8		9		10		11		12		
5													
6	18		17		16		15		14		13		
7													
8	19		20		21		22		23		24		
9													
10	30		29		28		27		26		25		
11													
12	31		32		33		34		35		36		
13													

A. Description of original monument and accessories and/or subsequent restoration:

1. CORNER NOT SET IN ORIGINAL GOVERNMENT SURVEY.

2. THERE IS NO OTHER MENTION OF THE CORNER IN THE EATON COUNTY PUBLIC RECORDS

3. BRYAN LAND SURVEYS SET A 1/2" BAR & CAP 3.5' EAST OF A NORTH-SOUTH FENCE LINE, AT THE INTERSECTION OF 1/4 LINES, AFTER A GPS TRAVERSES OF SECTION 36, T2N, R5W, IN AN ACT 132 SURVEY IN AUGUST 1997: SET 60D NAIL IN SOUTH SIDE 7" MAPLE, WEST, 1.83'; SET 60D NAIL IN 8" MAPLE, N02°E, 4.78'; SET 60D NAIL IN EAST SIDE 12" OAK, SOUTH, 7.93'; SET 1/2" BAR & CAP #25832, NORTH, 165.00'

B. Description of corner evidence found and/or method applied in restoring or reestablishing corner:

SEARCHED AT APPARENT LOCATION OF CORNER AND FOUND 1/2" BAR & CAP #25832, 3.5' EAST OF A NORTH-SOUTH FENCE LINE, MATCHING BRYAN'S WITNESSES EXCEPT FOR TRANSPOSITION OF BEARINGS AND TYPES OF TREES. ACCEPTED BAR & CAP AS CORNER. REPLACED 1/2" BAR & CAP WITH 3/4" BAR & PA345 CAP AND SET STANDARD BAR & CAP. BRYAN LAND SURVEYS MEASURED NORTH 2661.74' TO L-11, SOUTH 2655.76' TO L-13, EAST 2656.47' TO M-12 AND WEST 2655.87' TO K-12.

C. Description of monument for corner and accessories established to perpetuate locating the position of the corner:

L-12 T2N, R5W

3/4' BAR & ORANGE PLASTIC CAP IMPRINTED PA 345 PS 25837 3.5' EAST OF NORTH-SOUTH FENCE LINE

FOUND 1/2" BAR & CAP #25832 AT FENCE CORNER, 0° NAZ, 165.00'

FOUND 60D SPIKE IN EAST SIDE 8" MAPLE, 190° NAZ, 4.78'

FOUND 60D SPIKE IN EAST SIDE 14" CHERRY, 354° NAZ, 7.93'

FOUND 60D SPIKE IN SOUTH SIDE 7" MAPLE, 75° NAZ, 1.84'

SET NAIL & TAG #25837 IN WEST SIDE 15" ASH, 180° NAZ, 37.25'

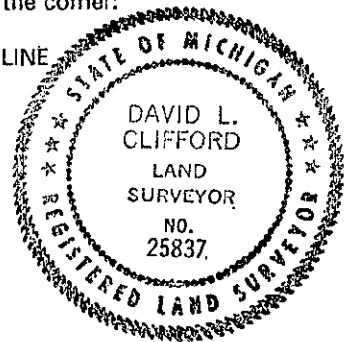

Signed by David L. Clifford

Date OCTOBER 11, 1997

Surveyor's Michigan License No. 25837

FORM APPROVED BY MICHIGAN STATE BOARD OF PROFESSIONAL SURVEYORS,  
JAN. 28, 1971  
REVISED MAY 14, 1975  
REVISED JAN., 1983  
REVISED OCT., 1995

P.A. 345 EATON COUNTY  
PEER APPROVED 10/14/97 m